

BSP Adaptors

Adaptors male-female

Reducer adaptor male BSP 60° - fixed female BSP

Stainless Steel AISI 316-L

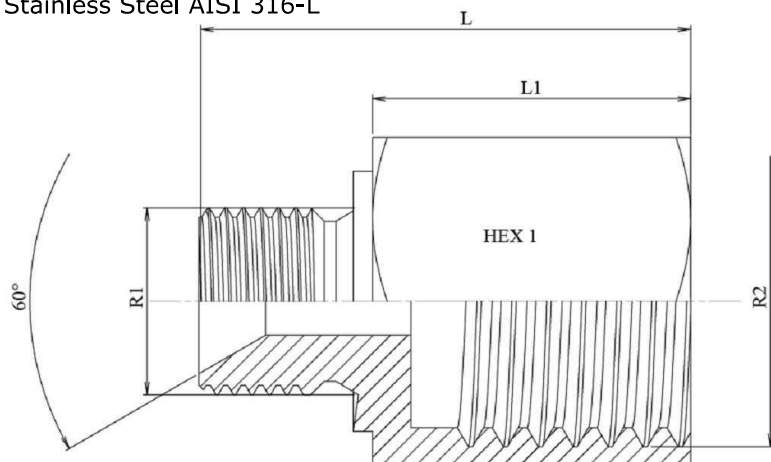

Part n°	R1	R2	L	L1	HEX 1	ØC
XR3110204	M 1/8" BSP	F 1/4" BSP	30	21	19	3,5
XR3110206	M 1/8" BSP	F 3/8" BSP	26	17	22	3,5
XR3110402	M 1/4" BSP	F 1/8" BSP	31	18	17	6
XR3110406	M 1/4" BSP	F 3/8" BSP	31	18	22	6
XR3110408	M 1/4" BSP	F 1/2" BSP	38	25	27	6
XR3110604	M 3/8" BSP	F 1/4" BSP	35	21	22	8
XR3110608	M 3/8" BSP	F 1/2" BSP	39	25	27	8
XR3110804	M 1/2" BSP	F 1/4" BSP	38.5	21	27	11
XR3110806	M 1/2" BSP	F 3/8" BSP	39.5	22	27	11
XR3110812	M 1/2" BSP	F 3/4" BSP	44	26,5	32	11
XR3110816	M 1/2" BSP	F 1" BSP	45.5	28,5	41	11
XR3111206	M 3/4" BSP	F 3/8" BSP	35.5	17	32	15
XR3111208	M 3/4" BSP	F 1/2" BSP	40.5	22	32	16
XR3111216	M 3/4" BSP	F 1" BSP	47	28,5	41	16
XR3111612	M 1" BSP	F 3/4" BSP	48	26,5	41	22
XR3111620	M 1" BSP	F 1"1/4 BSP	53.5	32	50	22
XR3111624	M 1" BSP	F 1"1/2 BSP	59.5	40	55	22,2
XR3112016	M 1"1/4 BSP	F 1" BSP	53.5	28,5	50	30
XR3112420	M 1"1/2 BSP	F 1"1/4 BSP	59	32	55	33
XR3112432	M 1"1/2 BSP	F 2" BSP	68	40	70	33
XR3113224	M 2" BSP	F 1"1/2 BSP	68	40	70	46