

**VENTILER - MOTION CONTROL VALVES**

**VUI**

**KONTRA VENTIL  
CHECK VALVE ( BALL TYPE )**

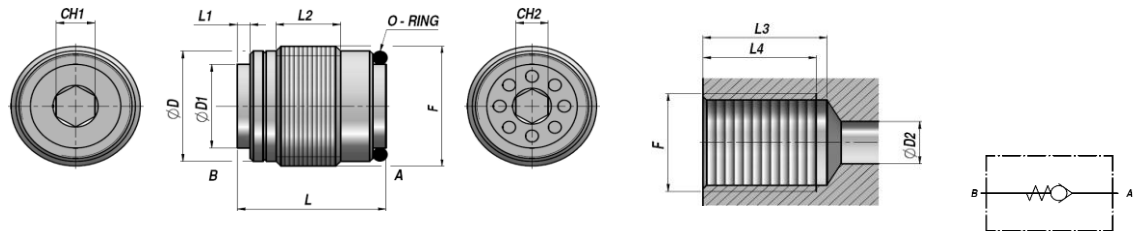

Varenr. Code	F BSP	Q MAX l/min	P MAX bar	Type	L	L1	L2	ØD	ØD1	CH1	CH2	L3	L4	ØD2	kg x 100
VCG301.100000	1/4"	18	350	VUI 010	17	1	6	11.3	9,2	3	3	28	25	8	1,00
VCG301.200000	3/8"	25	350	VUI 020	18.5	1.8	7.5	14.8	11	4	3	30	27	9	2,00
VCG301.300000	1/2"	50	350	VUI 030	23	1.8	9.5	18.5	14	6	5	36	32	12	4,00
VCG301.400000	3/4"	78	350	VUI 040	28.5	2.7	14,5	24	19	8	8	42	37	17	7,00

Åbningstryk - Opening pressure : bar 0,5

PATRONE  
CARTRIDGE

MATERIALE - MATERIAL : STÅL - STEEL