

**PG3-G**

**TANDHJUL PUMPE  
GEAR PUMP**

**GR.3**

**STANDARD EU  $\varnothing$ 50,5 FLANGE  
STANDARD EUROPEAN  $\varnothing$ 50,5 FLANGE**

**KONISK AKSEL 1:8  
1:8 TAPER SHAFT**

STØBEJERNS FLANGE OG COVER  
CAST IRON FLANGE AND COVER

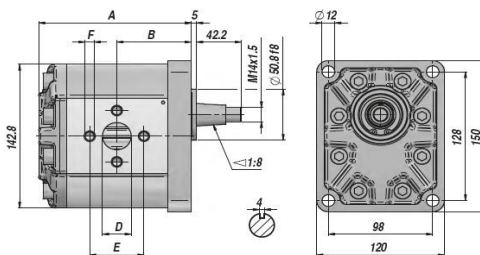
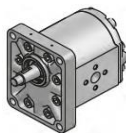

Varenr. Code	Type	cm <sup>3</sup> /omg. cm <sup>3</sup> /rev	P MAX bar		omdr./min rpm		A	B	IN D x E x F	OUT D x E x F	kg
			P1	P3	MAX	MIN					
PG3G119*0011000	PG3-G 19 S/D 10N	19.30	290	335	3500	700	128.30	62.40	$\varnothing$ 27x51xM10	$\varnothing$ 19x40xM8	7.67
PG3G123*0011000	PG3-G 23 S/D 10N	23.00	290	335	3500	700	131.30	63.90	$\varnothing$ 27x51xM10	$\varnothing$ 19x40xM8	7.81
PG3G130*0011000	PG3-G 30 S/D 10N	30.20	280	323	3300	700	137.30	66.90	$\varnothing$ 27x51xM10	$\varnothing$ 19x40xM8	8.09
PG3G134*0011000	PG3-G 34 S/D 10N	33.80	280	323	3300	700	140.30	68.40	$\varnothing$ 27x51xM10	$\varnothing$ 19x40xM8	8.22
PG3G137*0011000	PG3-G 37 S/D 10N	37.50	280	323	3300	700	143.30	69.90	$\varnothing$ 27x51xM10	$\varnothing$ 19x40xM8	8.36
PG3G144*0011000	PG3-G 44 S/D 10N	44.60	260	300	3000	700	149.30	72.90	$\varnothing$ 27x51xM10	$\varnothing$ 19x40xM8	8.64
PG3G153*0011000	PG3-G 53 S/D 10N	53.00	240	277	3000	700	156.30	76.40	$\varnothing$ 27x51xM10	$\varnothing$ 19x40xM8	8.96
PG3G162*0011000	PG3-G 62 S/D 10N	62.70	200	231	2500	700	164.30	80.40	$\varnothing$ 27x51xM10	$\varnothing$ 19x40xM8	9.33
PG3G170*0011000	PG3-G 70 S/D 10N	70.50	180	208	2500	700	170.80	86.90	$\varnothing$ 27x51xM10	$\varnothing$ 19x40xM8	9.63
PG3G177*0011000	PG3-G 77 S/D 10N	77.20	170	196	2200	700	176.30	92.40	$\varnothing$ 27x51xM10	$\varnothing$ 19x40xM8	9.88

\* 1= ANTICLOCKWISE  
\* 0= CLOCKWISE

P1 = MAX. ARBEJDSTRYK - MAX. WORKING PRESSURE  
P3 = MAX. BELASTNING - MAX. PEAK PRESSURE



**FLANGER - AVAILABLE FLANGES**

SAE-B

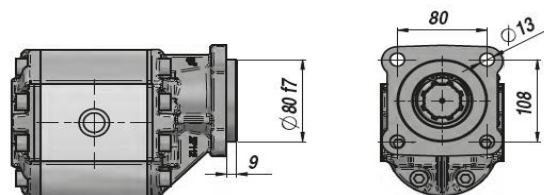
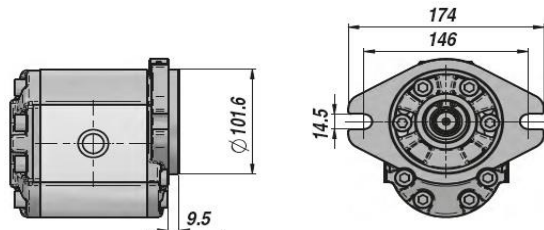
ZFC

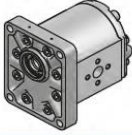
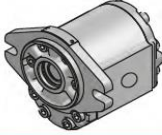

AKSLER - AVAILABLE SHAFTS

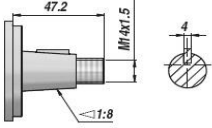
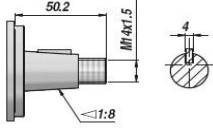
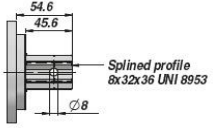
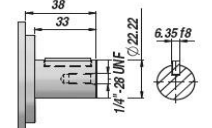
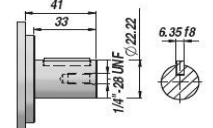
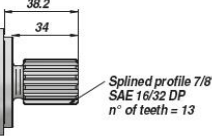
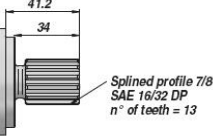
EURO	SAE-B	ZFC		
				
10 	10 	24 		
13 	13 			
14 	14 			

TILSLUTNINGER - CONNECTIONS

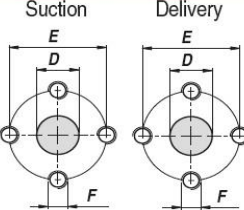
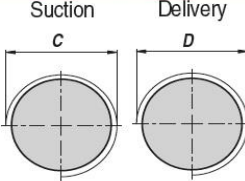
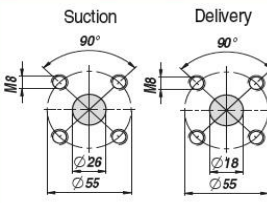
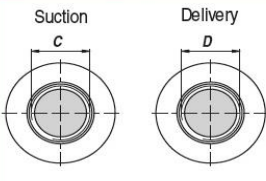
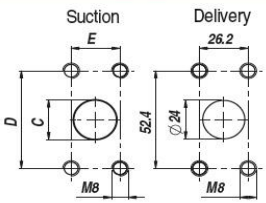
N (EURO)	G (GAS)	T (BOSCH)	W (UNF)	F (SAE)
<p>Suction Delivery</p> 	<p>Suction Delivery</p> 	<p>Suction Delivery</p> 	<p>Suction Delivery</p> 	<p>Suction Delivery</p> 
<p>Dimensions : see table on the left</p>	<p>C= 1" - D= 3/4" (cm³ 19 ÷ 62) C= 1 1/4" - D= 1" (cm³ 70 ÷ 77)</p>		<p>C= 1 5/16" - D= 1 1/16" (cm³ 19 ÷ 30) C= 1 5/8" - D= 1 5/16" (cm³ 34 ÷ 62) C= 1 7/8" - D= 1 5/8" (cm³ 70 ÷ 77)</p>	<p>C= 27 - D= 52.4 - E= 26.2 (cm³ 19÷36) C= 42 - D= 35.6 - E= 69.8 (cm³ 44÷77)</p>