

STANDARD DOBBELT VIRKENDE CYLINDER
STANDARD DOUBLE ACTING CYLINDER

HMO

Series M250

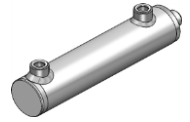
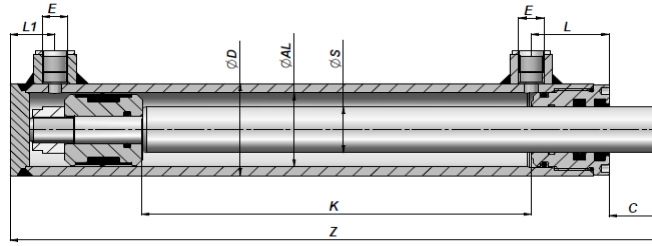

Varenr. Code	K	Z	kg	E BSP	L	L1	C	Varenr. Code	K	Z	kg				
ØD 70 ØAL 60 ØS 40								ØD 73 ØAL 63 ØS 40							
HMO3400200	200	360	7.25					HMO063400200	200	360	7.60				
HMO3400250	250	410	8.14					HMO063400250	250	410	8.50				
HMO3400300	300	460	9.03					HMO063400300	300	460	9.40				
HMO3400350	350	510	9.90					HMO063400350	350	510	10,30				
HMO3400400	400	560	10,79					HMO063400400	400	560	11,20				
HMO3400450	450	610	11,64	3/8"	50	30	23	HMO063400450	450	610	12,10				
HMO3400500	500	660	12,52					HMO063400500	500	660	13,00				
HMO3400550	550	710	13,45					HMO063400550	550	710	13,90				
HMO3400600	600	760	14,30					HMO063400600	600	760	14,80				
HMO3400700 NEW!	700	860	16,23					HMO063400700 NEW!	700	860	16,64				
HMO3400800	800	960	17,82					HMO063400800	800	960	18,50				
HMO3401000	1000	1160	21,40					HMO063401000	1000	1160	22,10				
ØD 80 ØAL 70 ØS 35												ØD 80 ØAL 70 ØS 40			
HMO4350100	100	260	6.09									HMO4400100 NEW!	100	260	6.48
HMO4350150	150	310	6.95									HMO4400150 NEW!	150	310	7.43
HMO4350200	200	360	7.74					HMO4400200	200	360	8.28				
HMO4350250	250	410	8.60					HMO4400250	250	410	9.26				
HMO4350300	300	460	9.40					HMO4400300	300	460	10,24				
HMO4350350	350	510	10,26	3/8"	50	33	23	HMO4400350	350	510	11,20				
HMO4350400	400	560	11,00					HMO4400400	400	560	12,80				
HMO4350450	450	610	11,88					HMO4400450	450	610	13,11				
HMO4350500	500	660	12,60					HMO4400500	500	660	14,01				
HMO4350550	550	710	13,66					HMO4400550	550	710	15,10				
HMO4350600	600	760	14,20					HMO4400600	600	760	15,99				
HMO4350700 NEW!	700	860	16,15					HMO4400700 NEW!	700	860	17,91				
HMO4350800	800	960	17,56					HMO4400800	800	960	19,73				
HMO4351000	1000	1160	21,26					HMO4401000	1000	1160	23,51				
ØD 92 ØAL 80 ØS 40												ØD 92 ØAL 80 ØS 50			
HMO5400200	200	380	11,08					HMO5500200	200	380	12,35				
HMO5400250	250	430	12,22					HMO5500250	250	430	13,73				
HMO5400300	300	480	13,35					HMO5500300	300	480	15,15				
HMO5400400	400	580	15,56					HMO5500400	400	580	17,95				
HMO5400500	500	680	17,77	1/2"	60	35	25	HMO5500500	500	680	20,71				
HMO5400600	600	780	19,98					HMO5500600	600	780	24,00				
HMO5400700 NEW!	700	880	22,47					HMO5500700 NEW!	700	880	26,50				
HMO5400800	800	980	24,50					HMO5500800	800	980	29,50				
HMO5401000	1000	1180	28,92					HMO5501000	1000	1180	35,00				
ØD 105 ØAL 90 ØS 50															
HMO090500300	300	486	19,30												
HMO090500400	400	586	22,64												
HMO090500500	500	686	25,97												
HMO090500600	600	786	29,30					1/2"	60	40	23				
HMO090500700 NEW!	700	886	32,63												
HMO090500800	800	986	35,97												
HMO090501000	1000	1186	42,64												
ØD 115 ØAL 100 ØS 50												ØD 115 ØAL 100 ØS 60			
HMO6500200	200	410	19,50												
HMO6500250	250	460	21,50												
HMO6500300	300	510	23,00					HMO6600300	300	510	25,50				
HMO6500400	400	610	26,50	1/2"	82	38	25	HMO6600400	400	610	29,50				
HMO6500500	500	710	30,00					HMO6600500	500	710	33,50				
HMO6500600	600	810	33,50					HMO6600600	600	810	37,50				
HMO6500700 NEW!	700	910	37,21					HMO6600700 NEW!	700	910	42,10				
HMO6500800	800	1010	40,50					HMO6600800	800	1010	46,00				
HMO6501000	1000	1210	47,50					HMO6601000	1000	1210	54,50				

MATERIALE RØR : STÅL St 52.3 DIN 2393 ISO H9

TUBE MATERIAL : STEEL St 52.3 DIN 2393 ISO H9

MATERIALE STANG : STÅL UNI C45 SAE 1045 CROMO 25 MICRON ±5 Rating 9 / 120 h ISO 10289 - 1999/ISO 9227-NSS

ROD MATERIAL : STEEL UNI C45 SAE 1045 CHROME 25 MICRON ±5 Rating 9 / 120 h ISO 10289 - 1999/ISO 9227-NSS

TEKNIKE SPECIFIKATIONER : SE SIDE 2 - TECHNICAL SPECIFICATIONS : SEE PAGE 2

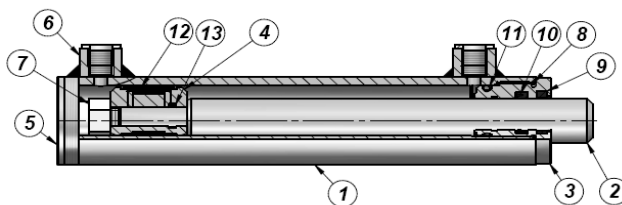
TEKNISKE SPECIFIKATIONER
TECHNICAL SPECIFICATIONS
TYPE " HMO " - " HMOLM "

"HMO" Max Tryk - Max. Pressure : 250 bar (**)
 "HMOLM" Max Tryk - Max. Pressure : 180 bar

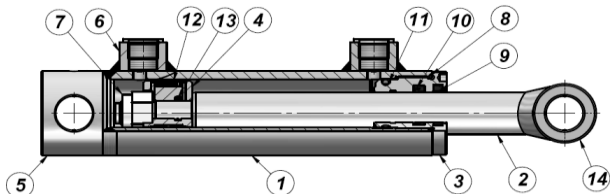
TYPE " HFR2S "

"HFR2S" Pressione Massima - Max. Pressure : 250 bar (**)

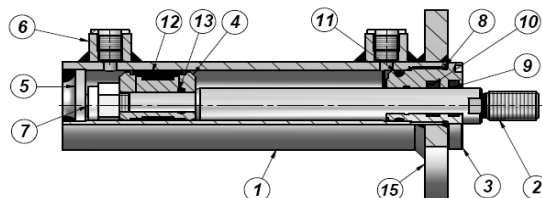
TYPE " HMF "

"HMF" Pressione Massima - Max. Pressure : 250 bar (**)

PRODUKT - PRODUCT
MATERIALE - MATERIAL

1	CYL. RØR POLISHED TUBE	STÅL : St 52.3 DIN 2393 ISO H9 STEEL : St 52.3 DIN 2393 ISO H9
2	STEMPELSTANG CHROMED ROD	STÅL : UNI C45 - SAE 1045 - CROMO 25 Micron ±5 Rating 9 / 120 h ISO 10289 - 1999/ISO 9227-NSS STEEL : UNI C45 - SAE 1045 - CHROME 25 Micron ±5 Rating 9 / 120 h ISO 10289 - 1999/ISO 9227-NSS
3	PAKBOKS HEAD-BUSH	STØBEGODS HYDRAULIC CAST IRON
4	STEMPEL PISTON	STÅL : 95Mn28 STEEL : 95Mn28
5	ENDEBUND END-PLUG	STÅL : S355J0 (Fe510C) - S355JR (A105) STEEL : S355J0 (Fe510C) - S355JR (A105)
6	GEVINDSTUDS THREADED PORT	STÅL : 95Mn28 - C22 STEEL : 95Mn28 - C22
7	LÅSEMØTRIK LOCKNUT	STÅL : UNI 7473 - 7474 STEEL : UNI 7473 - 7474
8	PAKNING : O-RING SEAL : O-RING	NBR 70 SHORE NBR 70 SHORE
9	PAKNING : GHK SEAL : GHK	POLYURETHAN POLYURETHANE
10	PAKNING : TSE-TTS-TTI/L SEAL : TSE-TTS-TTI/L	TSE : NBR+TESSUTO TTS-TTI/L: POLYURETHAN TSE : NBR+FABRIC TTS-TTI/L: POLYURETHANE
11	PAKNING : O-RING SEAL : O-RING	NBR 70 SHORE NBR 70 SHORE
12	PAKNING : TPM SEAL : TPM	NBR+POM+POLYESTER NBR+POM+POLYESTER
13	PAKNING : O-RING SEAL : O-RING	NBR 70 SHORE NBR 70 SHORE
14	FASTØJE BUSH	STÅL : S355J0 (Fe510C) STEEL : S355J0 (Fe510C)
15	FLANGE FLANGE	STÅL : S355J0 (Fe510C) STEEL : S355J0 (Fe510C)

Max Hastighed - Top Speed : max 0,5 m/s

Temperatur C° - Temperature C° : -25 °C - +80 °C

(**) Spidsbelastningen bør altid kontrolleres afhængigt af brugen af cylindrene.
 (**) The pressure value is always to be checked depending on the application of the cylinders.

TEKNISKE SPECIFIKATIONER
TECHNICAL SPECIFICATIONS

TRYKKRAFT - OUTPUT FORCE

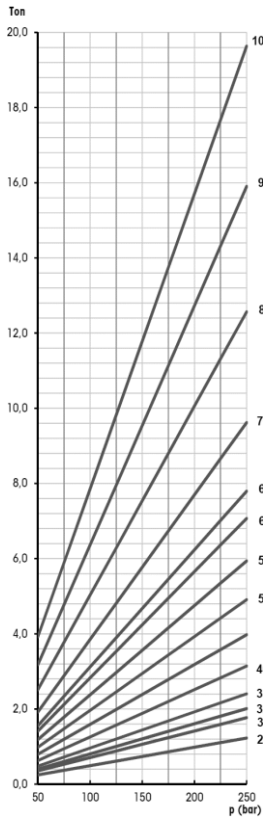

TRÆKKRAFT - INPUT FORCE

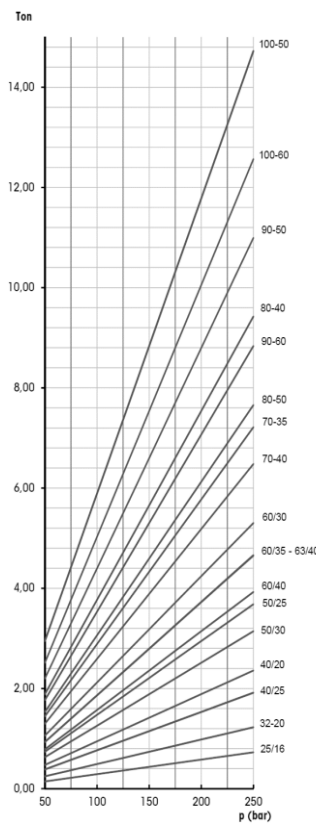

UDBØJNING - BUCKLING (HMO)

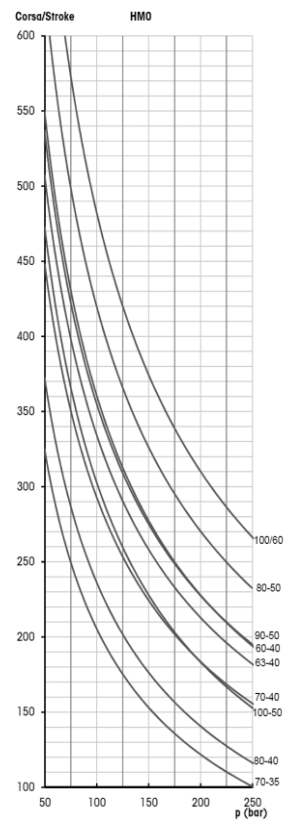
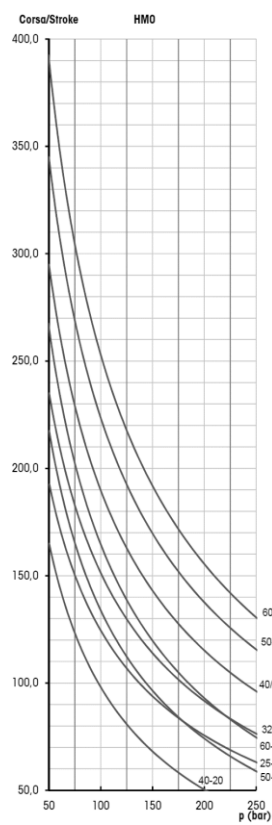

UDBØJNING - BUCKLING (HFR)

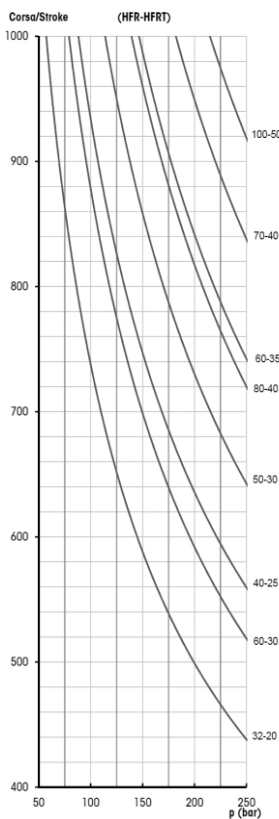

UDBØJNING - BUCKLING (HMF)

