

PLUNGER CYLINDER TYPE "HFRT"  
 PLUNGER CYLINDER "HFRT" TYPE

HFRT

Series M250

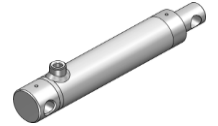
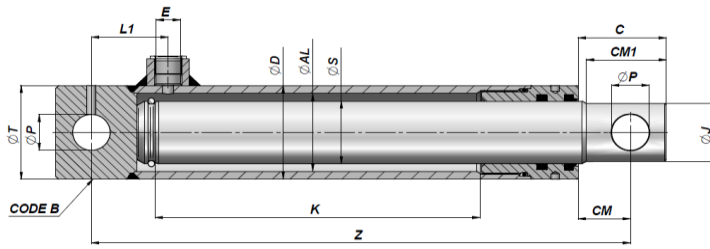

Varenr. Code	K	Z	kg	E BSP	L1	ØP	CM	C	ØJ	CM1	ØT	Code B
<b>ØD 40 ØAL 30 ØS 25</b>												
HFRT125100	100	190	1,63	3/8"	40	14,10	24	38	22	35	40	CFHR030014030
HFRT125150	150	240	2,04									
HFRT125200	200	290	2,44									
HFRT125250	250	340	2,85									
HFRT125300	300	390	3,26									
<b>ØD 50 ØAL 40 ØS 30</b>												
HFRT230200	200	300	3,61	3/8"	42	16,20	26	42	27	37	50	CF04005016
HFRT230250	250	350	4,16									
HFRT230300	300	400	4,72									
HFRT230350	350	450	5,27									
HFRT230400	400	500	5,82									
HFRT230550	550	650	7,30									
HFRT230700 <b>NEW!</b>	700	800	9,18									
<b>ØD 60 ØAL 50 ØS 40</b>												
HFRT340200	200	330	6,00	3/8"	47	23,10	32	54	37	49	60	CFHR050023050
HFRT340250	250	380	6,84									
HFRT340300	300	430	7,67									
HFRT340350	350	480	8,49									
HFRT340400	400	530	9,32									
HFRT340550	550	680	11,70									
HFRT340700	700	830	14,10									
<b>ØD 60 ØAL 50 ØS 45</b>												
HFRT345200 <b>NEW!</b>	200	330	6,73	3/8"	47	23,10	34	56	42	49	60	CFHR0502.3050
HFRT345250 <b>NEW!</b>	250	380	7,69									
HFRT345300 <b>NEW!</b>	300	430	8,66									
HFRT345350 <b>NEW!</b>	350	480	9,62									
HFRT345400 <b>NEW!</b>	400	530	10,58									
<b>ØD 70 ØAL 60 ØS 50</b>												
HFRT450300	300	460	11,80	3/8"	50	25,50	49	74	47	65	65	CFHRT07060
HFRT450400	400	560	14,00									
HFRT450550	550	710	17,50									
HFRT450700	700	860	21,00									
<b>ØD 80 ØAL 70 ØS 60</b>												
HFRT560200 <b>NEW!</b>	200	360	12,26	3/8"	50	25,25	36	61	57	57	75	CFHRT08070
HFRT560300 <b>NEW!</b>	300	460	15,40									
HFRT560400 <b>NEW!</b>	400	560	18,53									
HFRT560550 <b>NEW!</b>	550	710	23,24									
HFRT560700 <b>NEW!</b>	700	860	27,95									
<b>ØD 92 ØAL 80 ØS 70</b>												
HFRT570300 <b>NEW!</b>	300	509	22,66	3/8"	55	30,25	66	96	67	90	85	CFHRT09080
HFRT570400 <b>NEW!</b>	400	609	26,94									
HFRT570500 <b>NEW!</b>	500	709	31,23									

CYL. RØR : STÅL St 52.3 DIN 2393 ISO H9

MATERIALE STANG : STÅL UNI C45 SAE 1045 CROMO 25 MICRON ±5 Rating 9 / 120 h ISO 10289 - 1999/ISO 9227-NSS

TUBE MATERIAL : STEEL St 52.3 DIN 2393 ISO H9

ROD MATERIAL : STEEL UNI C45 SAE 1045 CHROME 25 MICRON ±5 Rating 9 / 120 h ISO 10289 - 1999/ISO 9227-NSS

**TEKNISKE SPECIFIKATIONER**  
**TECHNICAL SPECIFICATIONS**

TYPE "HTO"

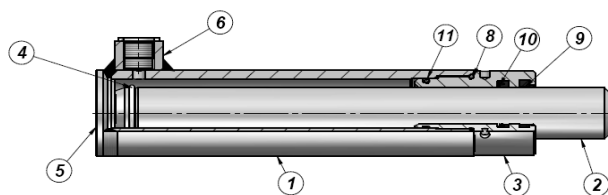

"HTO" Max Tryk - Max. Pressure : 250 bar (\*\*)

TYPE "HFRT"

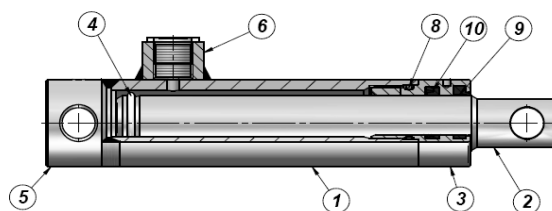

"HFRT" Max Tryk - Max. Pressure : 250 bar (\*\*)

PRODUKT - PRODUCT			MATERIALE - MATERIAL		
1	CYL.RØR POLISHED TUBE		STÅL : STEEL :	St 52.3 DIN 2393 ISO H9 St 52.3 DIN 2393 ISO H9	
2	STEMPELSTANG CHROMED ROD		STÅL : STEEL :	UNI C45 - SAE 1045 - CROMO 25 Micron ±5 Rating 9 / 120 h ISO 10289 - 1999/ISO 9227-NSS UNI C45 - SAE 1045 - CHROME 25 Micron ±5 Rating 9 / 120 h ISO 10289 - 1999/ISO 9227-NSS	
3	PAKBOKS HEAD-BUSH	TYPE : "HTO" TYPE : "HTO"	STØBEGODS HYDRAULIC CAST IRON	UNI 5007-G25 UNI 5007-G25	
3	PAKBOKS HEAD-BUSH	TYPE : "HFRT" TYPE : "HFRT"	STÅL 9SMn28 MED "NI-TEMPER" BEHANDLING STEEL 9SMn28 WITH "NI-TEMPER" TREATMENT		
4	LÅSERING STOP RING		STÅL : STEEL :	9SMn28 9SMn28	
5	ENDEBUND END-PLUG		STÅL : STEEL :	S355J0 ( Fe510C ) - S355JR ( A105 ) S355J0 ( Fe510C ) - S355JR ( A105 )	
6	TILSLUTNINGSTUDS THREADED PORT		STÅL : STEEL :	9SMn28 - C22 9SMn28 - C22	
8	PAKNING : SEAL :	O-RING O-RING	TYPE : "HTO" TYPE : "HTO"	NBR 70 SHORE NBR 70 SHORE	
8	PAKNING : SEAL :	O-RING O-RING	TYPE : "HFRT" TYPE : "HFRT"	NBR 90 SHORE NBR 90 SHORE	
9	PAKNING : SEAL :	GHK GHK		POLYURETHAN POLYURETHANE	
10	PAKNING : SEAL :	TSE-TTS-TTI/L TSE-TTS-TTI/L		TSE : NBR+FABRIC TSE : NBR+FABRIC	TTS-TTI/L: POLYURETHAN TTS-TTI/L: POLYURETHANE
11	PAKNING : SEAL :	O-RING O-RING		NBR 70 SHORE NBR 70 SHORE	

Max Hastighed - Top Speed : max 0,5 m/s

Temperatur C° - Temperature C° : -25 °C - +80 °C

(\*\*) Spidsbelastningen bør altid kontrolleres afhængigt af brugen af cylindrene.  
 (\*\*) The pressure value is always to be checked depending on the application of the cylinders.

TEKNISKE SPECIFIKATIONER  
TECHNICAL SPECIFICATIONS

TRYKKRAFT - OUTPUT FORCE (HTO)

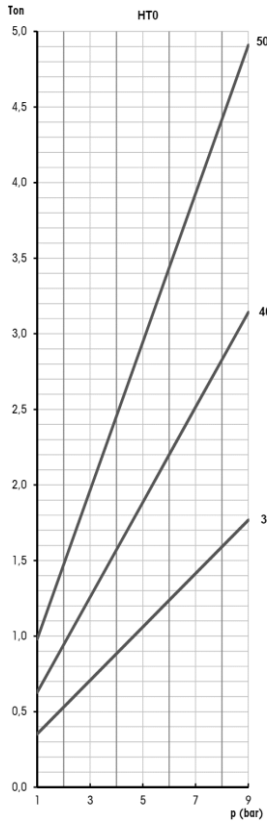

TRYKKRAFT - OUTPUT FORCE (HFRT)

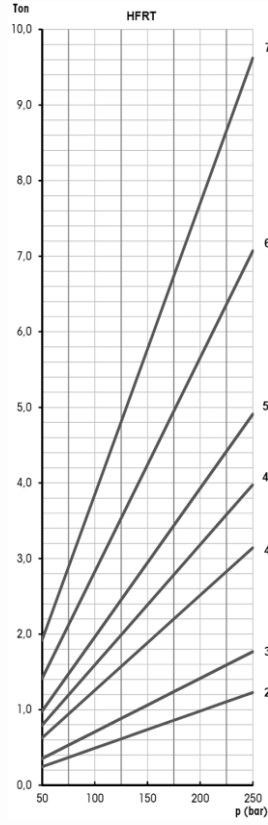

UDBØJNING - BUCKLING (HTO)

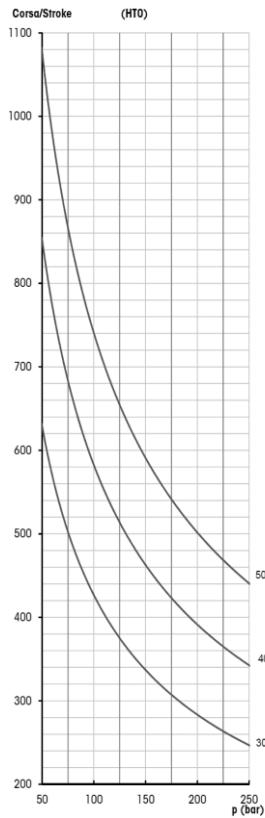

UDBØJNING - BUCKLING (HFRT)

