

DOBBELT VIRKENDE CYLINDER TYPE "HFR2S"  
DOUBLE ACTING CYLINDER "HFR2S" TYPE

HFR2S

Series M250

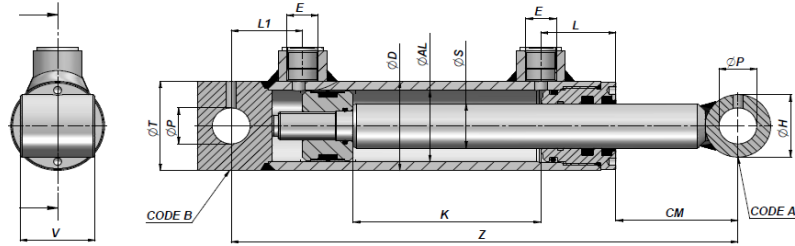

Varenr. Code	K	Z	kg	E BSP	L	L1	CM	ØP	ØH	V	ØT	Code A	Code B	Varenr. Code	K	Z	kg
<b>ØD 70 ØAL 60 ØS 30</b>				<b>ØD 70 ØAL 60 ØS 35</b>													
HFR2S0600300100	100	300	5,60	3/8"	50	36	83	25,25	40	45	70	CBF1025040045	CFHR060025047	HFR2S0600350100	100	300	5.85
HFR2S0600300150	150	350	6,30											HFR2S0600350150	150	350	6.62
HFR2S0600300200	200	400	7,00											HFR2S0600350200	200	400	7.50
HFR2S0600300250	250	450	7,70											HFR2S0600350250	250	450	8.18
HFR2S0600300300	300	500	8,30											HFR2S0600350300	300	500	9.00
HFR2S0600300350	350	550	9,00											HFR2S0600350350	350	550	9.73
HFR2S0600300400	400	600	9,70											HFR2S0600350400	400	600	10.60
HFR2S0600300450	450	650	10.40											HFR2S0600350450	450	650	11,28
HFR2S0600300500	500	700	11.00											HFR2S0600350500	500	700	12,10
HFR2S0600300600	600	800	12.40											HFR2S0600350600	600	800	13,70
HFR2S0600300700	700	900	13.70	HFR2S0600350700	700	900	15,20										
<b>ØD 80 ØAL 70 ØS 40</b>				<b>ØD 80 ØAL 70 ØS 45</b>													
HFR2S0700400200	200	410	10,10	3/8"	50	46	82	30,25	50	55	80	CBF1030050055	CFHR070030063	HFR2S0700450100	100	410	10,10
HFR2S0700400250	250	460	11,00											HFR2S0700450150	150	460	11,00
HFR2S0700400300	300	510	12,00											HFR2S0700450200	200	510	12,00
HFR2S0700400350	350	560	13,00											HFR2S0700450250	250	560	13,00
HFR2S0700400400	400	610	13,90											HFR2S0700450300	300	610	13,90
HFR2S0700400450	450	660	14,90											HFR2S0700450350	350	660	14,90
HFR2S0700400500	500	710	15,80											HFR2S0700450400	400	710	15,80
HFR2S0700400600	600	810	17,70											HFR2S0700450450	450	810	17,70
HFR2S0700400700	700	910	19,60											HFR2S0700450500	500	910	19,60
HFR2S0700400800	800	1010	21,50											HFR2S0700450600	600	1010	21,50
HFR2S0700400900	900	1110	23,40	HFR2S0700450700	700	1110	23,40										
HFR2S0700401000	1000	1210	25,32	HFR2S0700450800	800	1210	25,32										
<b>ØD 92 ØAL 80 ØS 40</b>				<b>ØD 92 ØAL 80 ØS 45</b>													
HFR2S0800400200	200	410	13,00	3/8"	60	42	70	30,25	50	55	90	CBF1030050055	CFHR080030060	HFR2S0800450100	100	410	13,00
HFR2S0800400250	250	460	14,20											HFR2S0800450150	150	460	14,20
HFR2S0800400300	300	510	15,30											HFR2S0800450200	200	510	15,30
HFR2S0800400350	350	560	16,40											HFR2S0800450250	250	560	16,40
HFR2S0800400400	400	610	17,50											HFR2S0800450300	300	610	17,50
HFR2S0800400450	450	660	18,60											HFR2S0800450350	350	660	18,60
HFR2S0800400500	500	710	19,80											HFR2S0800450400	400	710	19,80
HFR2S0800400600	600	810	22,00											HFR2S0800450450	450	810	22,00
HFR2S0800400700	700	910	24,30											HFR2S0800450500	500	910	24,30
HFR2S0800400800	800	1010	26,50											HFR2S0800450600	600	1010	26,50
HFR2S0800400900	900	1110	28,80	HFR2S0800450700	700	1110	28,80										
HFR2S0800401000	1000	1210	31,00	HFR2S0800450800	800	1210	31,00										
<b>ØD 115 ØAL 100 ØS 50</b>				<b>ØD 115 ØAL 100 ØS 55</b>													
HFR2S1000500200	200	425	21,50	1/2"	66	45	75	30,25	60	70	115	CBF1030060070	CFHR100030063	HFR2S1000550100	100	425	21,50
HFR2S1000500300	300	525	25,00											HFR2S1000550150	150	525	25,00
HFR2S1000500400	400	625	28,50											HFR2S1000550200	200	625	28,50
HFR2S1000500500	500	725	32,00											HFR2S1000550250	250	725	32,00
HFR2S1000500700	700	925	39,10											HFR2S1000550300	300	925	39,10
HFR2S1000500900	900	1125	46,10											HFR2S1000550400	400	1125	46,10
HFR2S1000501000	1000	1225	49,60	HFR2S1000550500	500	1225	49,60										

MATERIALE RØR : STÅL St 52.3 DIN 2393 ISO H9

MATERIALE STANG : STÅL UNI C45 SAE 1045 CROMO 25 MICRON ±5 Rating 9 / 120 h ISO 10289 - 1999/ISO 9227-NSS

TUBE MATERIAL : STEEL St 52.3 DIN 2393 ISO H9

ROD MATERIAL : STEEL UNI C45 SAE 1045 CHROME 25 MICRON ±5 Rating 9 / 120 h ISO 10289 - 1999/ISO 9227-NSS

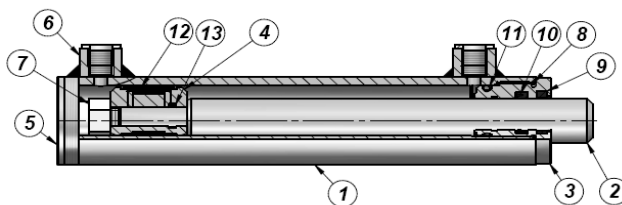
**TEKNISKE SPECIFIKATIONER**  
**TECHNICAL SPECIFICATIONS**
**TYPE " HMO " - " HMOLM "**

"HMO" Max Tryk - Max. Pressure : 250 bar (\*\*)  
 "HMOLM" Max Tryk - Max. Pressure : 180 bar

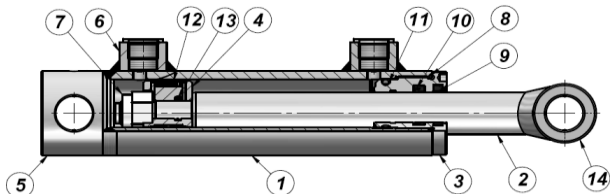
**TYPE " HFR2S "**

"HFR2S" Pressione Massima - Max. Pressure : 250 bar (\*\*)

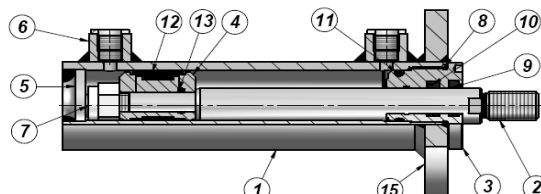
**TYPE " HMF "**

"HMF" Pressione Massima - Max. Pressure : 250 bar (\*\*)

**PRODUKT - PRODUCT**
**MATERIALE - MATERIAL**

1	CYL. RØR POLISHED TUBE	STÅL : St 52.3 DIN 2393 ISO H9 STEEL : St 52.3 DIN 2393 ISO H9
2	STEMPELSTANG CHROMED ROD	STÅL : UNI C45 - SAE 1045 - CROMO 25 Micron ±5 Rating 9 / 120 h ISO 10289 - 1999/ISO 9227-NSS STEEL : UNI C45 - SAE 1045 - CHROME 25 Micron ±5 Rating 9 / 120 h ISO 10289 - 1999/ISO 9227-NSS
3	PAKBOKS HEAD-BUSH	STØBEGODS HYDRAULIC CAST IRON
4	STEMPEL PISTON	STÅL : 9SMn28 STEEL : 9SMn28
5	ENDEBUND END-PLUG	STÅL : S355J0 ( Fe510C ) - S355JR ( A105 ) STEEL : S355J0 ( Fe510C ) - S355JR ( A105 )
6	GEVINDSTUDS THREADED PORT	STÅL : 9SMn28 - C22 STEEL : 9SMn28 - C22
7	LÅSEMØTRIK LOCKNUT	STÅL : UNI 7473 - 7474 STEEL : UNI 7473 - 7474
8	PAKNING : O-RING SEAL : O-RING	NBR 70 SHORE NBR 70 SHORE
9	PAKNING : GHK SEAL : GHK	POLYURETHAN POLYURETHANE
10	PAKNING : TSE-TTS-TTI/L SEAL : TSE-TTS-TTI/L	TSE : NBR+TESSUTO TTS-TTI/L: POLYURETHAN TSE : NBR+FABRIC TTS-TTI/L: POLYURETHANE
11	PAKNING : O-RING SEAL : O-RING	NBR 70 SHORE NBR 70 SHORE
12	PAKNING : TPM SEAL : TPM	NBR+POM+POLYESTER NBR+POM+POLYESTER
13	PAKNING : O-RING SEAL : O-RING	NBR 70 SHORE NBR 70 SHORE
14	FASTØJE BUSH	STÅL : S355J0 ( Fe510C ) STEEL : S355J0 ( Fe510C )
15	FLANGE FLANGE	STÅL : S355J0 ( Fe510C ) STEEL : S355J0 ( Fe510C )

Max Hastighed - Top Speed : max 0,5 m/s

Temperatur C° - Temperature C° : -25 °C - +80 °C

(\*\*) Spidsbelastningen bør altid kontrolleres afhængigt af brugen af cylindrene.  
 (\*\*) The pressure value is always to be checked depending on the application of the cylinders.

TEKNISKE SPECIFIKATIONER  
TECHNICAL SPECIFICATIONS

TRYKKRAFT - OUTPUT FORCE

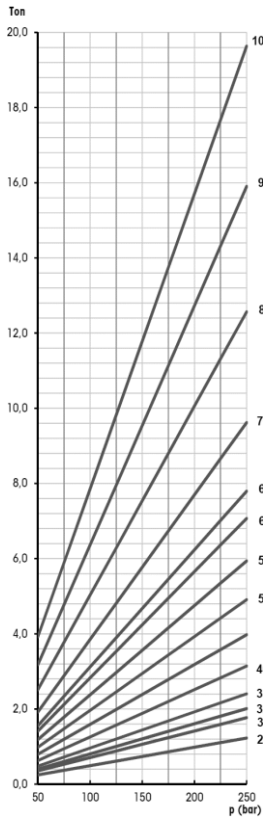

TRÆKKRAFT - INPUT FORCE

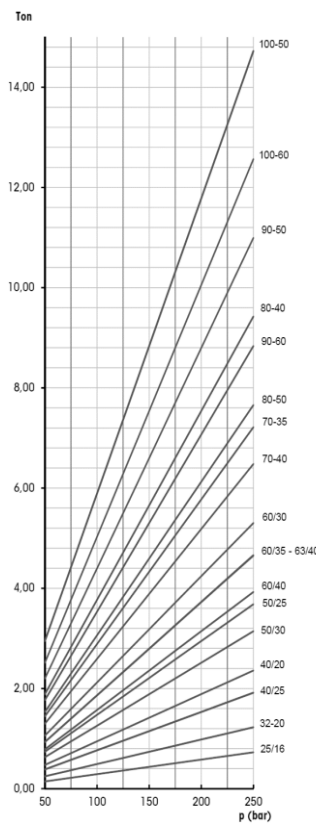

UDBØJNING - BUCKLING ( HMO )

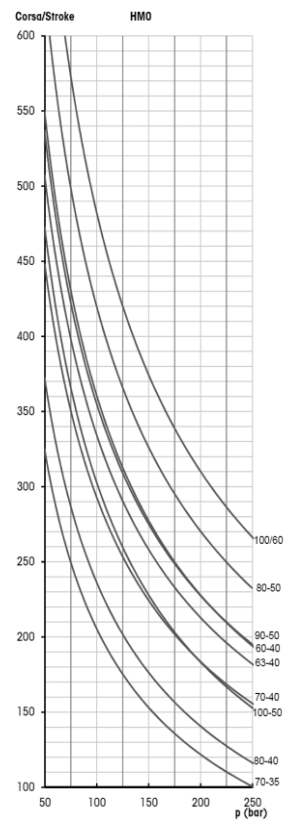
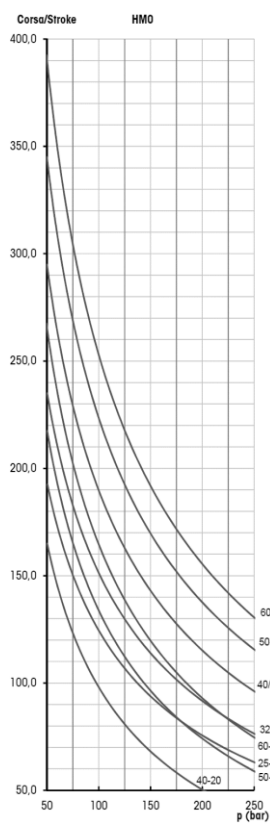

UDBØJNING - BUCKLING ( HFR )

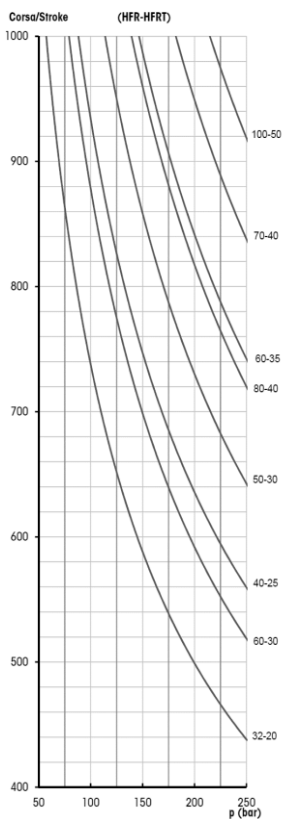

UDBØJNING - BUCKLING ( HMF )

