

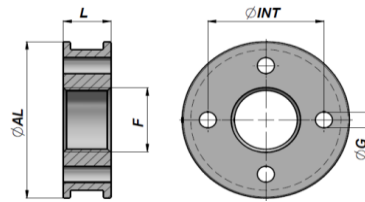

CTTB

NEW!

STYR FOR PLUNGER CYLINDER
PISTON FOR PLUNGER CYLINDER

Series M250

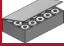

Varenr. Code	ØAL	F	L	ØG	ØINT	kg	Kasse Box		Pz Pcs	Pakn.sæt Seal kits	
CTTB0301215	30	M12x1.5	14	ø 3 x 4	20	0,05	Z50CTTB0301215		50	GKGCTTB03012	
CTTB0351415	35	M14x1.5	14	ø 4 x 4	23	0,07	Z50CTTB0351415		50	GKGCTTB03514	
CTTB0401415	40	M14x1.5	14	ø 4 x 4	27	0,10	Z50CTTB0401415		50	GKGCTTB04014	
CTTB0451615	45	M16x1.5	14	ø 4 x 4	32	0,13	Z50CTTB0451615		50	GKGCTTB04516	
CTTB0502015	50	M20x1.5	14	ø 5 x 4	34	0,14	Z50CTTB0502015		50	GKGCTTB05020	
CTTB0552015	55	M20x1.5	18	ø 5 x 4	38	0,23	Z50CTTB0552015		50	GKGCTTB05520	
CTTB0602015	60	M20x1.5	18	ø 6 x 4	42	0,29	Z50CTTB0602015		50	GKGCTTB06020	
CTTB0702420	70	M24x2	20	ø 7 x 4	50	0,45	Z50CTTB0702420		50	GKGCTTB07024	
CTTB0802720	80	M27x2	20	ø 7 x 4	60	0,61	Z40CTTB0802720		40	GKGCTTB08027	
CTTB0852720	85	M27x2	20	ø 7 x 4	65	0,71	Z20CTTB0852720		20	GKGCTTB08527	
CTTB0903320	90	M33x2	22	ø 7 x 6	68	0,84	Z20CTTB0903320		20	GKGCTTB09033	
CTTB1003320	100	M33x2	22	ø 8 x 6	76	1,08	Z20CTTB1003320		20	GKGCTTB10033	
CTTB1103930	110	M39x3	22	ø 8 x 6	86	1,30	Z15CTTB1103930		15	GKGCTTB11039	
CTTB1203930	120	M39x3	22	ø 10 x 6	93	1,57	Z10CTTB1203930		10	GKGCTTB12039	

MATERIALE : STÅL 9SMn28 - UNI C40

MATERIAL : STEEL 9SMn28 - UNI C40