

**AGG90**

90° SVIRVEL  
90° ROTARY COUPLING

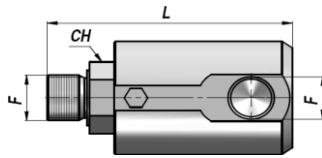

1/4" - 3/8" - 1/2" - 3/4" - 1"

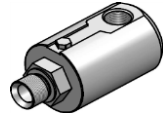
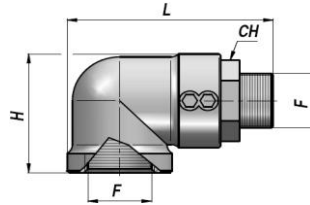

1"1/4 - 1"1/2 - 2"

Varenr. Code	F BSP	P MAX bar	L	H	CH	kg
AGG9040000	1/4"	200	71	-	19	0.28
AGG9060000	3/8"	200	77	-	24	0.40
AGG9080000	1/2"	150	86	-	27	0.55
AGG9120000	3/4"	150	100	-	34	1.05
AGG9160000	1"	100	113	-	41	1.45
AGG9200000	1"1/4	100	118	83	50	1.83
AGG9240000	1"1/2	100	138	100	55	3.00
AGG9320000	2"	90	152	110	65	3.54

P MAX: max. rotations tryk - max rotation pressure