

TANDHJULSPUMPER OG FLANGER - GEAR PUMPS AND CONNECTORS

XV2P

**TANDHJUL PUMPE
GEAR PUMP**

GR.2

**STANDARD EU ø36,5 FLANGE
STANDARD EUROPEAN ø36,5 FLANGE**

**KONISK AKSEL 1:8
1:8 TAPER SHAFT**

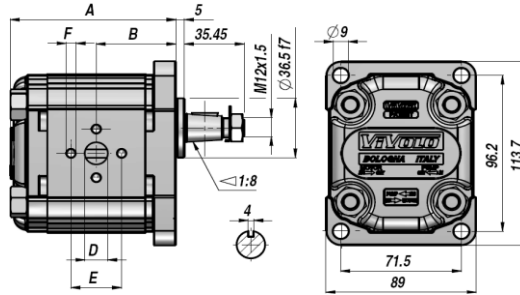
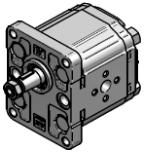

Varenr. Code	Type	cm ³ /omg. cm ³ /rev	P MAX bar		omdr./min rpm		A	B	IN D x E x F	OUT D x E x F	kg
			P1	P3	MAX	MIN					
2P410*EOOA	XV 2P/ 4	4.20	260	300	3500	700	87.2	41,7	ø13.5x30xM6	ø13.5x30xM6	2,20
2P430*EOOA	XV 2P/ 6	6.00	260	300	3500	700	90.2	43,2	ø13.5x30xM6	ø13.5x30xM6	2,30
2P450*EOOA	XV 2P/ 9	8.40	260	300	3500	700	94.2	45,2	ø13.5x30xM6	ø13.5x30xM6	2,40
2P470*EOOA	XV 2P/ 11	10.80	260	300	3500	700	98.2	47,2	ø13.5x30xM6	ø13.5x30xM6	2,50
2P490*EPOA	XV 2P/ 14	14.40	250	290	3500	700	104,2	50,2	ø20.0x40xM8	ø13.5x30xM6	2,70
2P510*EPOA	XV 2P/ 17	16.80	230	270	3500	700	108,2	52,2	ø20.0x40xM8	ø13.5x30xM6	2,80
2P530*EPOA	XV 2P/ 19	19.20	210	250	3000	700	112,2	54,2	ø20.0x40xM8	ø13.5x30xM6	2,90
2P550*EPOA	XV 2P/ 22	22.80	200	240	3000	700	118,2	57,2	ø20.0x40xM8	ø13.5x30xM6	3,05
2P570*EQPA	XV 2P/ 26	26.20	170	210	3000	700	122,2	59,2	ø23.5x40xM8	ø20.0x40xM8	3,15
2P590*EQPA	XV 2P/ 30	30.00	160	200	2500	700	130,2	63,2	ø23.5x40xM8	ø20.0x40xM8	3,40
2P610*EQPA	XV 2P/ 34	34.20	150	190	2500	700	137,2	66,7	ø23.5x40xM8	ø20.0x40xM8	3,60
2P630*EQPA	XV 2P/ 40	39.60	140	180	2000	700	146,2	71,2	ø23.5x40xM8	ø20.0x40xM8	3,80

* 1= ANTICLOCKWISE

* 2= CLOCKWISE

P1 = MAX. ARBEJDSTRYK - MAX. WORKING PRESSURE

P3 = MAX. BELASTNING - MAX. PEAK PRESSURE