

HFR2S

DOBBELT VIRKENDE CYLINDER TYPE "HFR2S"
DOUBLE ACTING CYLINDER "HFR2S" TYPE

Series M250

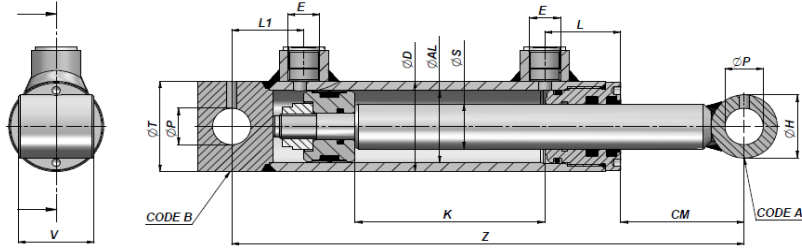
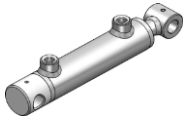

| Varenr. Code | K | Z | kg | E BSP | L | L1 | CM | ØP | ØH | V | ØT | Code A | Code B | Varenr. Code | K | Z | kg |
|---------------------------|------|------|-------|-------|----|----|----|-------|----|----|----|---------------|---------------|--------------|---|---|----|
| ØD 35 ØAL 25 ØS 16 | | | | | | | | | | | | | | | | | |
| HFR0160050 | 50 | 160 | 1,00 | | | | | | | | | | | | | | |
| HFR0160100 | 100 | 210 | 1,20 | | | | | | | | | | | | | | |
| HFR0160150 | 150 | 260 | 1,40 | 1/4" | 33 | 22 | 31 | 12,10 | 25 | 25 | 35 | CBF0012025025 | CFHR035025 | | | | |
| HFR0160200 | 200 | 310 | 1,70 | | | | | | | | | | | | | | |
| ØD 42 ØAL 32 ØS 20 | | | | | | | | | | | | | | | | | |
| HFR0200050 | 50 | 205 | 1,70 | | | | | | | | | | | | | | |
| HFR0200100 | 100 | 255 | 2,10 | | | | | | | | | | | | | | |
| HFR0200150 | 150 | 305 | 2,40 | | | | | | | | | | | | | | |
| HFR0200200 | 200 | 355 | 2,80 | | | | | | | | | | | | | | |
| HFR0200250 | 250 | 405 | 3,10 | | | | | | | | | | | | | | |
| HFR0200300 | 300 | 455 | 3,50 | 1/4" | 33 | 35 | 51 | 16,20 | 30 | 35 | 40 | CBF0016030035 | CFHR040032 | | | | |
| HFR0200400 | 400 | 555 | 4,20 | | | | | | | | | | | | | | |
| HFR0200500 | 500 | 655 | 4,80 | | | | | | | | | | | | | | |
| HFR0200600 | 600 | 755 | 5,56 | | | | | | | | | | | | | | |
| HFR0200700 | 700 | 855 | 6,26 | | | | | | | | | | | | | | |
| ØD 50 ØAL 40 ØS 25 | | | | | | | | | | | | | | | | | |
| HFR2S0400250100 | 100 | 270 | 3,00 | | | | | | | | | | | | | | |
| HFR2S0400250150 | 150 | 320 | 3,40 | | | | | | | | | | | | | | |
| HFR2S0400250200 | 200 | 370 | 3,90 | | | | | | | | | | | | | | |
| HFR2S0400250250 | 250 | 420 | 4,40 | | | | | | | | | | | | | | |
| HFR2S0400250300 | 300 | 470 | 4,80 | | | | | | | | | | | | | | |
| HFR2S0400250400 | 400 | 570 | 5,80 | 3/8" | 40 | 38 | 65 | 20,25 | 35 | 40 | 50 | CBF1020035040 | CFHR04002040 | | | | |
| HFR2S0400250500 | 500 | 670 | 6,70 | | | | | | | | | | | | | | |
| HFR2S0400250600 | 600 | 770 | 7,60 | | | | | | | | | | | | | | |
| HFR2S0400250700 | 700 | 870 | 8,60 | | | | | | | | | | | | | | |
| HFR2S0400250800 | 800 | 970 | 9,50 | | | | | | | | | | | | | | |
| HFR2S0400251000 | 1000 | 1170 | 11,37 | | | | | | | | | | | | | | |
| ØD 60 ØAL 50 ØS 30 | | | | | | | | | | | | | | | | | |
| HFR2S0500300100 | 100 | 300 | 4,40 | | | | | | | | | | | | | | |
| HFR2S0500300150 | 150 | 350 | 5,00 | | | | | | | | | | | | | | |
| HFR2S0500300200 | 200 | 400 | 5,60 | | | | | | | | | | | | | | |
| HFR2S0500300250 | 250 | 450 | 6,20 | | | | | | | | | | | | | | |
| HFR2S0500300300 | 300 | 500 | 6,90 | | | | | | | | | | | | | | |
| HFR2S0500300400 | 400 | 600 | 8,10 | | | | | | | | | | | | | | |
| HFR2S0500300500 | 500 | 700 | 9,30 | 3/8" | 43 | 42 | 85 | 25,25 | 40 | 45 | 60 | CBF1025040045 | CFHR050025049 | | | | |
| HFR2S0500300600 | 600 | 800 | 10,50 | | | | | | | | | | | | | | |
| HFR2S0500300700 | 700 | 900 | 11,80 | | | | | | | | | | | | | | |
| HFR2S0500300800 | 800 | 1000 | 13,00 | | | | | | | | | | | | | | |
| HFR2S0500300900 | 900 | 1100 | 14,20 | | | | | | | | | | | | | | |
| HFR2S0500301000 | 1000 | 1200 | 15,50 | | | | | | | | | | | | | | |

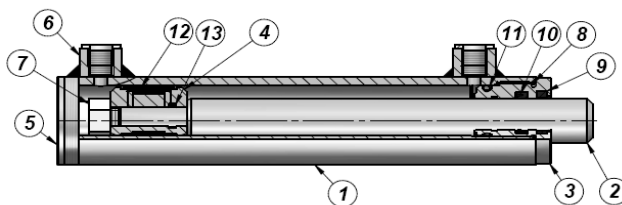
TEKNISKE SPECIFIKATIONER
TECHNICAL SPECIFICATIONS
TYPE " HMO " - " HMOLM "

"HMO" Max Tryk - Max. Pressure : 250 bar (**)
 "HMOLM" Max Tryk - Max. Pressure : 180 bar

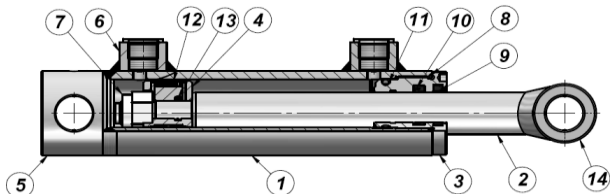
TYPE " HFR2S "

"HFR2S" Pressione Massima - Max. Pressure : 250 bar (**)

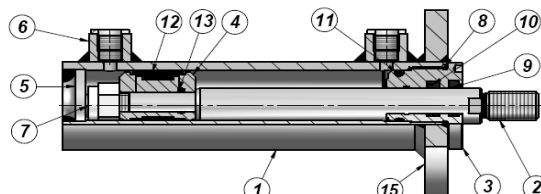
TYPE " HMF "

"HMF" Pressione Massima - Max. Pressure : 250 bar (**)

PRODUKT - PRODUCT
MATERIALE - MATERIAL

| | | |
|----|---|--|
| 1 | CYL. RØR POLISHED TUBE | STÅL : St 52.3 DIN 2393 ISO H9 STEEL : St 52.3 DIN 2393 ISO H9 |
| 2 | STEMPELSTANG CHROMED ROD | STÅL : UNI C45 - SAE 1045 - CROMO 25 Micron ±5 Rating 9 / 120 h ISO 10289 - 1999/ISO 9227-NSS STEEL : UNI C45 - SAE 1045 - CHROME 25 Micron ±5 Rating 9 / 120 h ISO 10289 - 1999/ISO 9227-NSS |
| 3 | PAKBOKS HEAD-BUSH | STØBEGODS HYDRAULIC CAST IRON |
| 4 | STEMPEL PISTON | STÅL : 95Mn28 STEEL : 95Mn28 |
| 5 | ENDEBUND END-PLUG | STÅL : S355J0 (Fe510C) - S355JR (A105) STEEL : S355J0 (Fe510C) - S355JR (A105) |
| 6 | GEVINDSTUDS THREADED PORT | STÅL : 95Mn28 - C22 STEEL : 95Mn28 - C22 |
| 7 | LÅSEMØTRIK LOCKNUT | STÅL : UNI 7473 - 7474 STEEL : UNI 7473 - 7474 |
| 8 | PAKNING : O-RING SEAL : O-RING | NBR 70 SHORE NBR 70 SHORE |
| 9 | PAKNING : GHK SEAL : GHK | POLYURETHAN POLYURETHANE |
| 10 | PAKNING : TSE-TTS-TTI/L SEAL : TSE-TTS-TTI/L | TSE : NBR+TESSUTO TTS-TTI/L: POLYURETHAN TSE : NBR+FABRIC TTS-TTI/L: POLYURETHANE |
| 11 | PAKNING : O-RING SEAL : O-RING | NBR 70 SHORE NBR 70 SHORE |
| 12 | PAKNING : TPM SEAL : TPM | NBR+POM+POLYESTER NBR+POM+POLYESTER |
| 13 | PAKNING : O-RING SEAL : O-RING | NBR 70 SHORE NBR 70 SHORE |
| 14 | FASTØJE BUSH | STÅL : S355J0 (Fe510C) STEEL : S355J0 (Fe510C) |
| 15 | FLANGE FLANGE | STÅL : S355J0 (Fe510C) STEEL : S355J0 (Fe510C) |

Max Hastighed - Top Speed : max 0,5 m/s

Temperatur C° - Temperature C° : -25 °C - +80 °C

(**) Spidsbelastningen bør altid kontrolleres afhængigt af brugen af cylindrene.
 (**) The pressure value is always to be checked depending on the application of the cylinders.

TEKNISKE SPECIFIKATIONER
TECHNICAL SPECIFICATIONS

TRYKKRAFT - OUTPUT FORCE

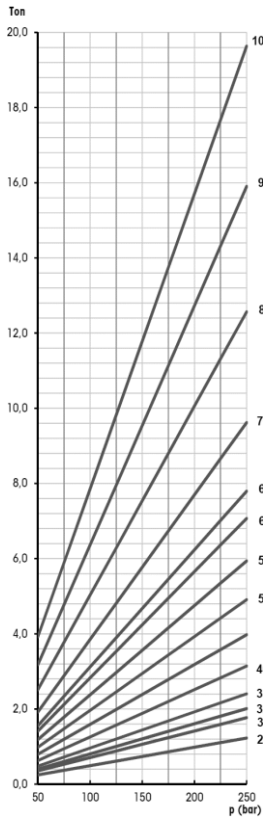

TRÆKKRAFT - INPUT FORCE

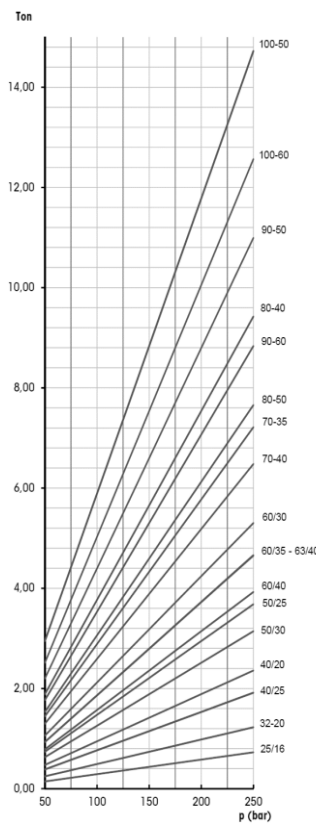

UDBØJNING - BUCKLING (HMO)

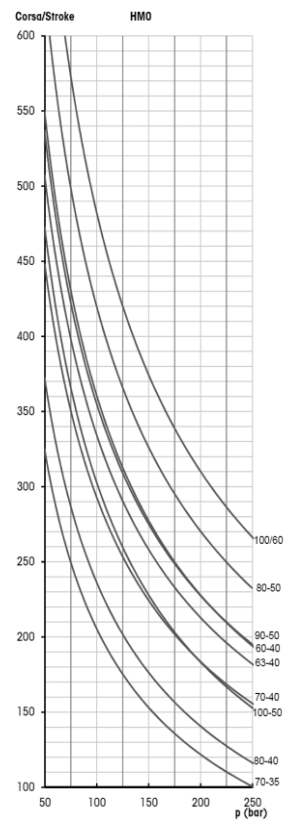
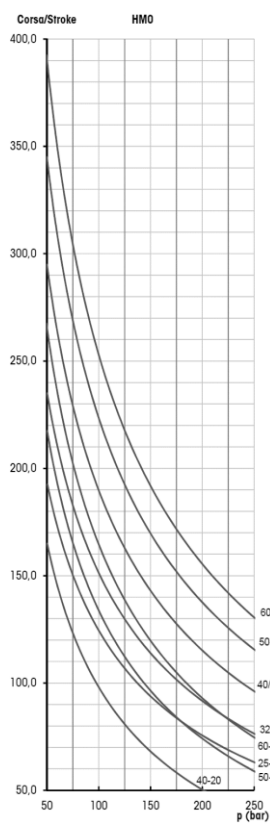

UDBØJNING - BUCKLING (HFR)

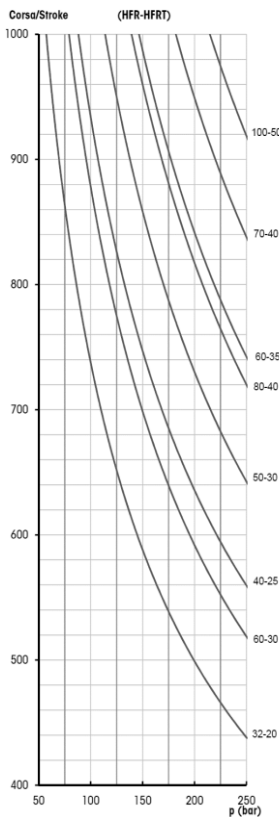

UDBØJNING - BUCKLING (HMF)

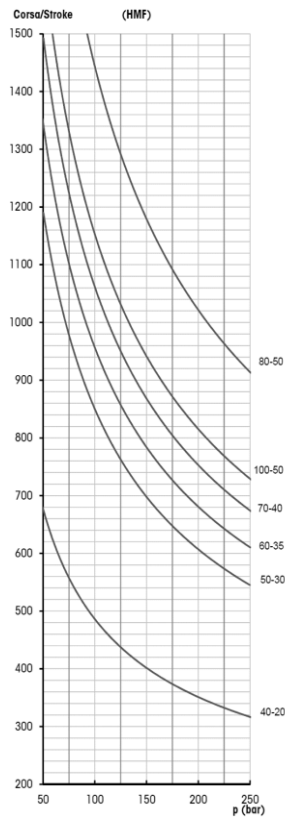

PLUNGER CYLINDER TYPE "HFRT"
 PLUNGER CYLINDER "HFRT" TYPE

HFRT

Series M250

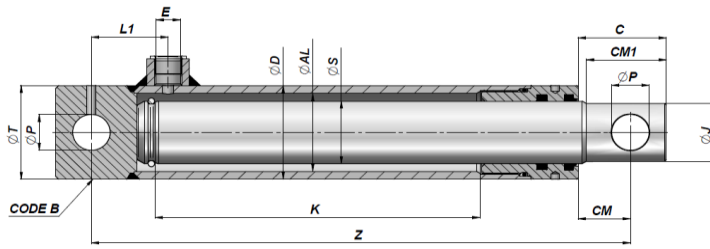

| Varenr. Code | K | Z | kg | E BSP | L1 | ØP | CM | C | ØJ | CM1 | ØT | Code B |
|---------------------------|-----|-----|-------|-------|----|-------|----|----|----|-----|----|---------------|
| ØD 40 ØAL 30 ØS 25 | | | | | | | | | | | | |
| HFRT125100 | 100 | 190 | 1,63 | 3/8" | 40 | 14,10 | 24 | 38 | 22 | 35 | 40 | CFHR030014030 |
| HFRT125150 | 150 | 240 | 2,04 | | | | | | | | | |
| HFRT125200 | 200 | 290 | 2,44 | | | | | | | | | |
| HFRT125250 | 250 | 340 | 2,85 | | | | | | | | | |
| HFRT125300 | 300 | 390 | 3,26 | | | | | | | | | |
| ØD 50 ØAL 40 ØS 30 | | | | | | | | | | | | |
| HFRT230200 | 200 | 300 | 3,61 | 3/8" | 42 | 16,20 | 26 | 42 | 27 | 37 | 50 | CF04005016 |
| HFRT230250 | 250 | 350 | 4,16 | | | | | | | | | |
| HFRT230300 | 300 | 400 | 4,72 | | | | | | | | | |
| HFRT230350 | 350 | 450 | 5,27 | | | | | | | | | |
| HFRT230400 | 400 | 500 | 5,82 | | | | | | | | | |
| HFRT230550 | 550 | 650 | 7,30 | | | | | | | | | |
| HFRT230700 NEW! | 700 | 800 | 9,18 | | | | | | | | | |
| ØD 60 ØAL 50 ØS 40 | | | | | | | | | | | | |
| HFRT340200 | 200 | 330 | 6,00 | 3/8" | 47 | 23,10 | 32 | 54 | 37 | 49 | 60 | CFHR050023050 |
| HFRT340250 | 250 | 380 | 6,84 | | | | | | | | | |
| HFRT340300 | 300 | 430 | 7,67 | | | | | | | | | |
| HFRT340350 | 350 | 480 | 8,49 | | | | | | | | | |
| HFRT340400 | 400 | 530 | 9,32 | | | | | | | | | |
| HFRT340550 | 550 | 680 | 11,70 | | | | | | | | | |
| HFRT340700 | 700 | 830 | 14,10 | | | | | | | | | |
| ØD 60 ØAL 50 ØS 45 | | | | | | | | | | | | |
| HFRT345200 NEW! | 200 | 330 | 6,73 | 3/8" | 47 | 23,10 | 34 | 56 | 42 | 49 | 60 | CFHR0502.3050 |
| HFRT345250 NEW! | 250 | 380 | 7,69 | | | | | | | | | |
| HFRT345300 NEW! | 300 | 430 | 8,66 | | | | | | | | | |
| HFRT345350 NEW! | 350 | 480 | 9,62 | | | | | | | | | |
| HFRT345400 NEW! | 400 | 530 | 10,58 | | | | | | | | | |
| ØD 70 ØAL 60 ØS 50 | | | | | | | | | | | | |
| HFRT450300 | 300 | 460 | 11,80 | 3/8" | 50 | 25,50 | 49 | 74 | 47 | 65 | 65 | CFHRT07060 |
| HFRT450400 | 400 | 560 | 14,00 | | | | | | | | | |
| HFRT450550 | 550 | 710 | 17,50 | | | | | | | | | |
| HFRT450700 | 700 | 860 | 21,00 | | | | | | | | | |
| ØD 80 ØAL 70 ØS 60 | | | | | | | | | | | | |
| HFRT560200 NEW! | 200 | 360 | 12,26 | 3/8" | 50 | 25,25 | 36 | 61 | 57 | 57 | 75 | CFHRT08070 |
| HFRT560300 NEW! | 300 | 460 | 15,40 | | | | | | | | | |
| HFRT560400 NEW! | 400 | 560 | 18,53 | | | | | | | | | |
| HFRT560550 NEW! | 550 | 710 | 23,24 | | | | | | | | | |
| HFRT560700 NEW! | 700 | 860 | 27,95 | | | | | | | | | |
| ØD 92 ØAL 80 ØS 70 | | | | | | | | | | | | |
| HFRT570300 NEW! | 300 | 509 | 22,66 | 3/8" | 55 | 30,25 | 66 | 96 | 67 | 90 | 85 | CFHRT09080 |
| HFRT570400 NEW! | 400 | 609 | 26,94 | | | | | | | | | |
| HFRT570500 NEW! | 500 | 709 | 31,23 | | | | | | | | | |

CYL. RØR : STÅL St 52.3 DIN 2393 ISO H9

MATERIALE STANG : STÅL UNI C45 SAE 1045 CROMO 25 MICRON ±5 Rating 9 / 120 h ISO 10289 - 1999/ISO 9227-NSS

TUBE MATERIAL : STEEL St 52.3 DIN 2393 ISO H9

ROD MATERIAL : STEEL UNI C45 SAE 1045 CHROME 25 MICRON ±5 Rating 9 / 120 h ISO 10289 - 1999/ISO 9227-NSS

TEKNISKE SPECIFIKATIONER
TECHNICAL SPECIFICATIONS

TYPE "HTO"

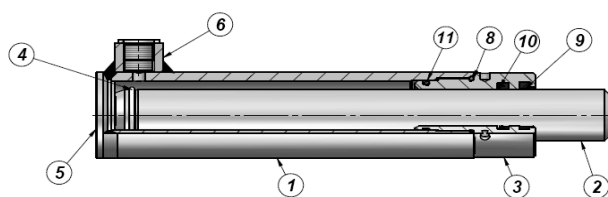

"HTO" Max Tryk - Max. Pressure : 250 bar (**)

TYPE "HFRT"

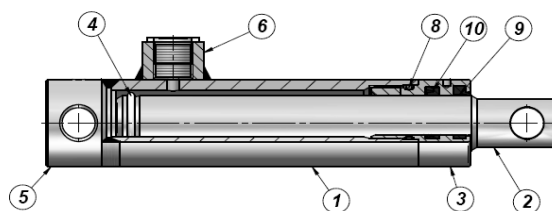

"HFRT" Max Tryk - Max. Pressure : 250 bar (**)

| PRODUKT - PRODUCT | | | MATERIALE - MATERIAL | | |
|-------------------|-----------------------------------|--------------------------------|----------------------------------|---|---|
| 1 | CYL.RØR POLISHED TUBE | | STÅL : STEEL : | St 52.3 DIN 2393 ISO H9 St 52.3 DIN 2393 ISO H9 | |
| 2 | STEMPELSTANG CHROMED ROD | | STÅL : STEEL : | UNI C45 - SAE 1045 - CROMO 25 Micron ±5 Rating 9 / 120 h ISO 10289 - 1999/ISO 9227-NSS UNI C45 - SAE 1045 - CHROME 25 Micron ±5 Rating 9 / 120 h ISO 10289 - 1999/ISO 9227-NSS | |
| 3 | PAKBOKS HEAD-BUSH | TYPE : "HTO" TYPE : "HTO" | STØBEGODS HYDRAULIC CAST IRON | UNI 5007-G25 UNI 5007-G25 | |
| 3 | PAKBOKS HEAD-BUSH | TYPE : "HFRT" TYPE : "HFRT" | STÅL STEEL : | 9SMn28 MED "NI-TEMPER" BEHANDLING 9SMn28 WITH "NI-TEMPER" TREATMENT | |
| 4 | LÅSERING STOP RING | | STÅL : STEEL : | 9SMn28 9SMn28 | |
| 5 | ENDEBUND END-PLUG | | STÅL : STEEL : | S355J0 (Fe510C) - S355JR (A105) S355J0 (Fe510C) - S355JR (A105) | |
| 6 | TILSLUTNINGSTUDS THREADED PORT | | STÅL : STEEL : | 9SMn28 - C22 9SMn28 - C22 | |
| 8 | PAKNING : SEAL : | O-RING O-RING | TYPE : "HTO" TYPE : "HTO" | NBR 70 SHORE NBR 70 SHORE | |
| 8 | PAKNING : SEAL : | O-RING O-RING | TYPE : "HFRT" TYPE : "HFRT" | NBR 90 SHORE NBR 90 SHORE | |
| 9 | PAKNING : SEAL : | GHK GHK | | POLYURETHAN POLYURETHANE | |
| 10 | PAKNING : SEAL : | TSE-TTS-TTI/L TSE-TTS-TTI/L | | TSE : NBR+FABRIC TSE : NBR+FABRIC | TTS-TTI/L: POLYURETHAN TTS-TTI/L: POLYURETHANE |
| 11 | PAKNING : SEAL : | O-RING O-RING | | NBR 70 SHORE NBR 70 SHORE | |

Max Hastighed - Top Speed : max 0,5 m/s

Temperatur C° - Temperature C° : -25 °C - +80 °C

(**) Spidsbelastningen bør altid kontrolleres afhængigt af brugen af cylindrene.
 (**) The pressure value is always to be checked depending on the application of the cylinders.

TEKNISKE SPECIFIKATIONER
TECHNICAL SPECIFICATIONS

TRYKKRAFT - OUTPUT FORCE (HTO)

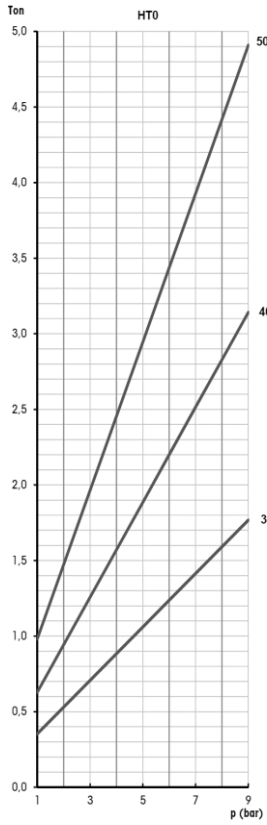

TRYKKRAFT - OUTPUT FORCE (HFRT)

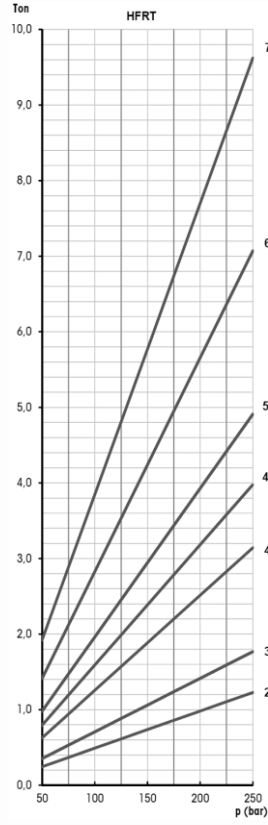

UDBØJNING - BUCKLING (HTO)

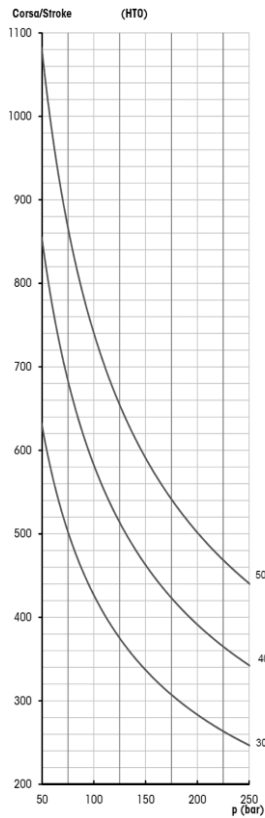

UDBØJNING - BUCKLING (HFRT)

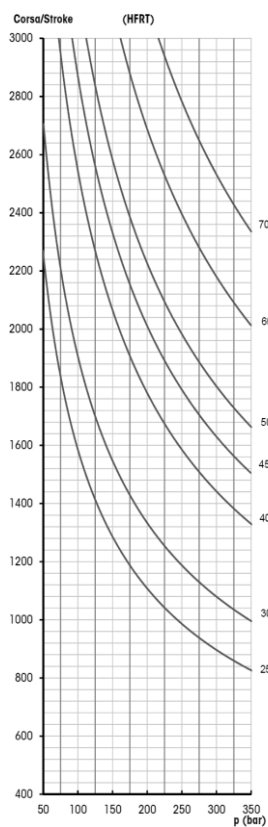

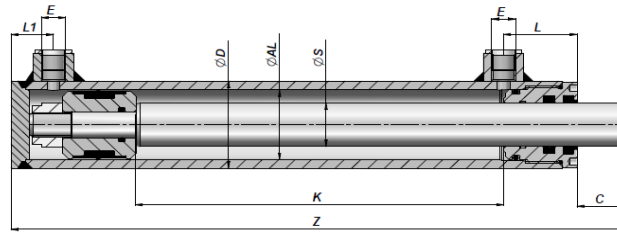
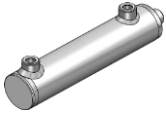

| Varenr. Code | K | Z | kg | E BSP | L | L1 | C | Varenr. Code | K | Z | kg |
|---------------------------|------|------|-------|-------|----|----|----|---------------------------|------|------|-------|
| ØD 35 ØAL 25 ØS 16 | | | | | | | | | | | |
| HM0025160050 | 50 | 135 | 0,70 | | | | | | | | |
| HM0025160100 | 100 | 185 | 0,95 | | | | | | | | |
| HM0025160150 | 150 | 235 | 1,25 | 1/4" | 33 | 15 | 17 | | | | |
| HM0025160200 | 200 | 285 | 1,50 | | | | | | | | |
| ØD 42 ØAL 32 ØS 20 | | | | | | | | | | | |
| HM0032200050 | 50 | 155 | 1,30 | | | | | | | | |
| HM0032200100 | 100 | 205 | 1,60 | | | | | | | | |
| HM0032200150 | 150 | 255 | 1,95 | | | | | | | | |
| HM0032200200 | 200 | 305 | 2,30 | 1/4" | 33 | 20 | 16 | | | | |
| HM0032200250 | 250 | 355 | 2,70 | | | | | | | | |
| HM0032200300 | 300 | 405 | 3,00 | | | | | | | | |
| HM0032200400 | 400 | 505 | 3,70 | | | | | | | | |
| HM0032200500 | 500 | 605 | 4,40 | | | | | | | | |
| ØD 50 ØAL 40 ØS 20 | | | | | | | | ØD 50 ØAL 40 ØS 25 | | | |
| HM01200100 | 100 | 230 | 2,27 | | | | | HM01250100 | 100 | 230 | 2,50 |
| HM01200150 | 150 | 280 | 2,67 | | | | | HM01250150 | 150 | 280 | 2,95 |
| HM01200200 | 200 | 330 | 3,05 | | | | | HM01250200 | 200 | 330 | 3,39 |
| HM01200250 | 250 | 380 | 3,45 | | | | | HM01250250 | 250 | 380 | 3,85 |
| HM01200300 | 300 | 430 | 3,85 | 1/4" | 40 | 23 | 22 | HM01250300 | 300 | 430 | 4,32 |
| HM01200350 | 350 | 480 | 4,27 | | | | | HM01250350 | 350 | 480 | 4,79 |
| HM01200400 | 400 | 530 | 4,65 | | | | | HM01250400 | 400 | 530 | 5,26 |
| HM01200450 | 450 | 580 | 5,08 | | | | | HM01250450 | 450 | 580 | 5,72 |
| HM01200500 | 500 | 630 | 5,49 | | | | | HM01250500 | 500 | 630 | 6,20 |
| | | | | | | | | HM01250550 | 550 | 680 | 6,60 |
| | | | | | | | | HM01250600 | 600 | 730 | 7,13 |
| ØD 60 ØAL 50 ØS 25 | | | | | | | | ØD 60 ØAL 50 ØS 30 | | | |
| HM02250100 | 100 | 240 | 3,29 | | | | | HM02300100 | 100 | 240 | 3,51 |
| HM02250150 | 150 | 290 | 3,83 | | | | | HM02300150 | 150 | 290 | 4,11 |
| HM02250200 | 200 | 340 | 4,34 | | | | | HM02300200 | 200 | 340 | 4,74 |
| HM02250250 | 250 | 390 | 4,85 | | | | | HM02300250 | 250 | 390 | 5,35 |
| HM02250300 | 300 | 440 | 5,35 | | | | | HM02300300 | 300 | 440 | 5,97 |
| HM02250350 | 350 | 490 | 5,94 | | | | | HM02300350 | 350 | 490 | 6,55 |
| HM02250400 | 400 | 540 | 6,40 | 3/8" | 43 | 26 | 22 | HM02300400 | 400 | 540 | 7,20 |
| HM02250450 | 450 | 590 | 7,30 | | | | | HM02300450 | 450 | 590 | 7,80 |
| HM02250500 | 500 | 640 | 7,43 | | | | | HM02300500 | 500 | 640 | 8,42 |
| HM02250550 | 550 | 690 | 8,06 | | | | | HM02300550 | 550 | 690 | 9,04 |
| HM02250600 | 600 | 740 | 8,46 | | | | | HM02300600 | 600 | 740 | 9,64 |
| HM02250700 | 700 | 840 | 9,66 | | | | | HM02300700 | 700 | 840 | 10,85 |
| HM02250800 | 800 | 940 | 10,71 | | | | | HM02300800 | 800 | 940 | 12,10 |
| HM02251000 | 1000 | 1140 | 12,87 | | | | | HM02301000 | 1000 | 1140 | 14,57 |
| ØD 70 ØAL 60 ØS 30 | | | | | | | | ØD 70 ØAL 60 ØS 35 | | | |
| HM03300100 | 100 | 260 | 4,82 | | | | | HM03350100 | 100 | 260 | 5,07 |
| HM03300150 | 150 | 310 | 5,55 | | | | | HM03350150 | 150 | 310 | 5,85 |
| HM03300200 | 200 | 360 | 6,20 | | | | | HM03350200 | 200 | 360 | 6,60 |
| HM03300250 | 250 | 410 | 6,87 | | | | | HM03350250 | 250 | 410 | 7,40 |
| HM03300300 | 300 | 460 | 7,55 | | | | | HM03350300 | 300 | 460 | 8,15 |
| HM03300350 | 350 | 510 | 8,20 | | | | | HM03350350 | 350 | 510 | 8,94 |
| HM03300400 | 400 | 560 | 8,90 | | | | | HM03350400 | 400 | 560 | 9,72 |
| HM03300450 | 450 | 610 | 9,53 | 3/8" | 50 | 30 | 23 | HM03350450 | 450 | 610 | 10,47 |
| HM03300500 | 500 | 660 | 10,25 | | | | | HM03350500 | 500 | 660 | 11,25 |
| HM03300550 | 550 | 710 | 10,86 | | | | | HM03350550 | 550 | 710 | 12,00 |
| HM03300600 | 600 | 760 | 11,60 | | | | | HM03350600 | 600 | 760 | 12,81 |
| HM03300700 | 700 | 860 | 12,99 | | | | | HM03350700 | 700 | 860 | 14,44 |
| HM03300800 | 800 | 960 | 14,26 | | | | | HM03350800 | 800 | 960 | 15,87 |
| HM03301000 | 1000 | 1160 | 17,00 | | | | | HM03351000 | 1000 | 1160 | 18,93 |

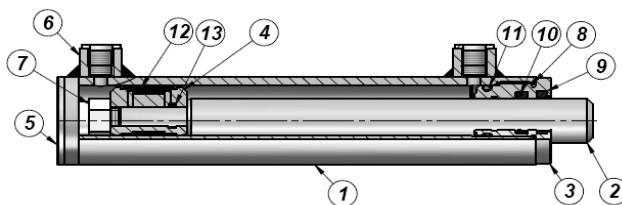
TEKNISKE SPECIFIKATIONER
TECHNICAL SPECIFICATIONS
TYPE " HMO " - " HMOLM "

"HMO" Max Tryk - Max. Pressure : 250 bar (**)
 "HMOLM" Max Tryk - Max. Pressure : 180 bar

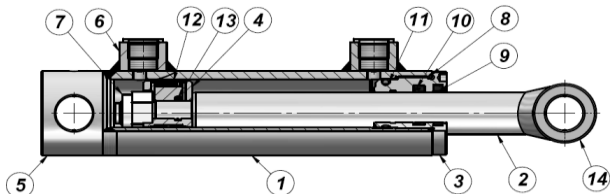
TYPE " HFR2S "

"HFR2S" Pressione Massima - Max. Pressure : 250 bar (**)

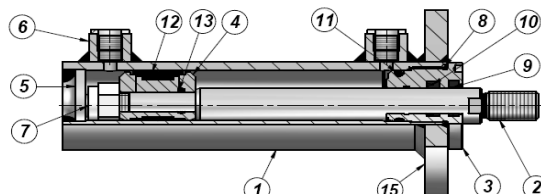
TYPE " HMF "

"HMF" Pressione Massima - Max. Pressure : 250 bar (**)

PRODUKT - PRODUCT
MATERIALE - MATERIAL

| | | |
|----|---|--|
| 1 | CYL. RØR POLISHED TUBE | STÅL : St 52.3 DIN 2393 ISO H9 STEEL : St 52.3 DIN 2393 ISO H9 |
| 2 | STEMPELSTANG CHROMED ROD | STÅL : UNI C45 - SAE 1045 - CROMO 25 Micron ±5 Rating 9 / 120 h ISO 10289 - 1999/ISO 9227-NSS STEEL : UNI C45 - SAE 1045 - CHROME 25 Micron ±5 Rating 9 / 120 h ISO 10289 - 1999/ISO 9227-NSS |
| 3 | PAKBOKS HEAD-BUSH | STØBEGODS HYDRAULIC CAST IRON |
| 4 | STEMPEL PISTON | STÅL : 95Mn28 STEEL : 95Mn28 |
| 5 | ENDEBUND END-PLUG | STÅL : S355J0 (Fe510C) - S355JR (A105) STEEL : S355J0 (Fe510C) - S355JR (A105) |
| 6 | GEVINDSTUDES THREADED PORT | STÅL : 95Mn28 - C22 STEEL : 95Mn28 - C22 |
| 7 | LÅSEMØTRIK LOCKNUT | STÅL : UNI 7473 - 7474 STEEL : UNI 7473 - 7474 |
| 8 | PAKNING : O-RING SEAL : O-RING | NBR 70 SHORE NBR 70 SHORE |
| 9 | PAKNING : GHK SEAL : GHK | POLYURETHAN POLYURETHANE |
| 10 | PAKNING : TSE-TTS-TTI/L SEAL : TSE-TTS-TTI/L | TSE : NBR+TESSUTO TTS-TTI/L: POLYURETHAN TSE : NBR+FABRIC TTS-TTI/L: POLYURETHANE |
| 11 | PAKNING : O-RING SEAL : O-RING | NBR 70 SHORE NBR 70 SHORE |
| 12 | PAKNING : TPM SEAL : TPM | NBR+POM+POLYESTER NBR+POM+POLYESTER |
| 13 | PAKNING : O-RING SEAL : O-RING | NBR 70 SHORE NBR 70 SHORE |
| 14 | FASTØJE BUSH | STÅL : S355J0 (Fe510C) STEEL : S355J0 (Fe510C) |
| 15 | FLANGE FLANGE | STÅL : S355J0 (Fe510C) STEEL : S355J0 (Fe510C) |

Max Hastighed - Top Speed : max 0,5 m/s

Temperatur C° - Temperature C° : -25 °C - +80 °C

(**) Spidsbelastningen bør altid kontrolleres afhængigt af brugen af cylindrene.
 (**) The pressure value is always to be checked depending on the application of the cylinders.

TEKNISKE SPECIFIKATIONER
TECHNICAL SPECIFICATIONS

TRYKKRAFT - OUTPUT FORCE

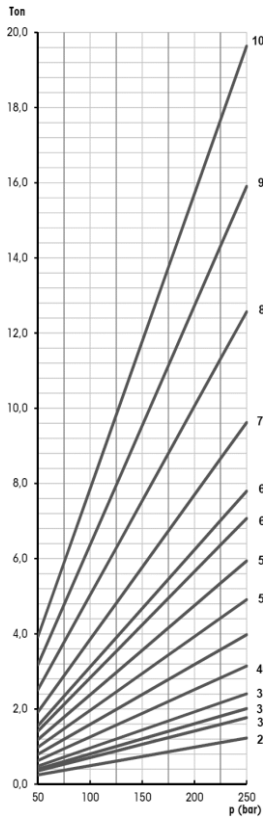

TRÆKKRAFT - INPUT FORCE

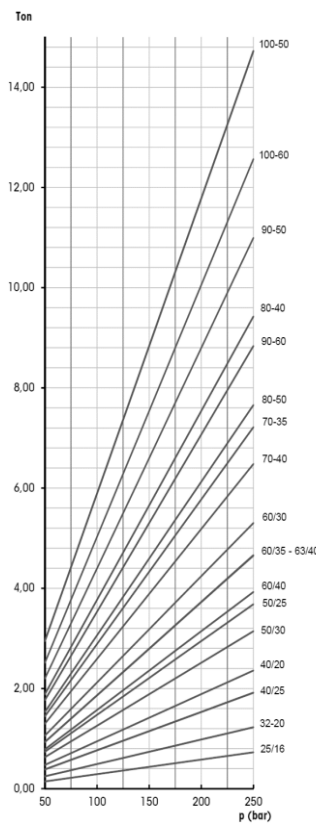

UDBØJNING - BUCKLING (HMO)

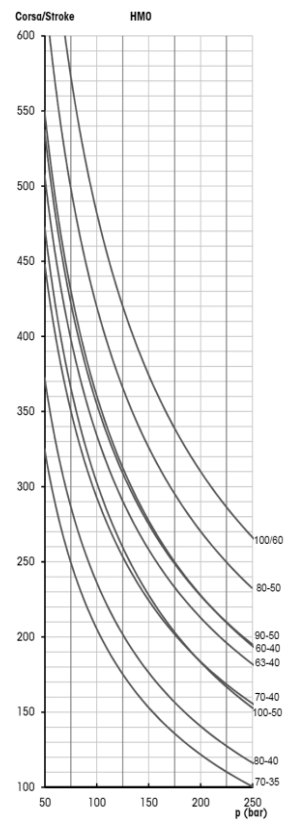
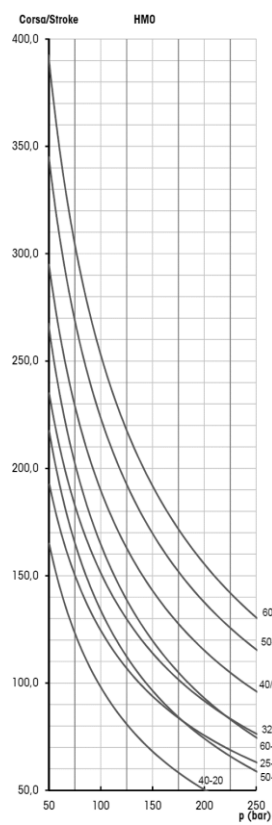

UDBØJNING - BUCKLING (HFR)

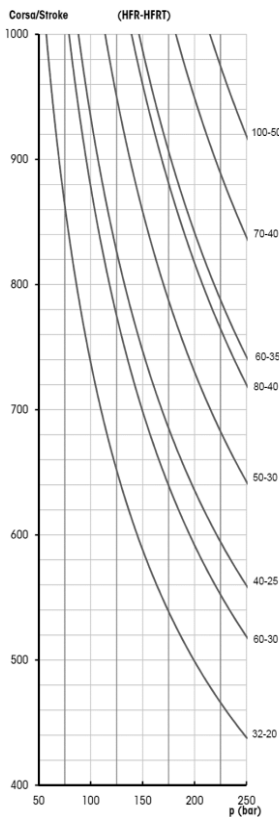

UDBØJNING - BUCKLING (HMF)

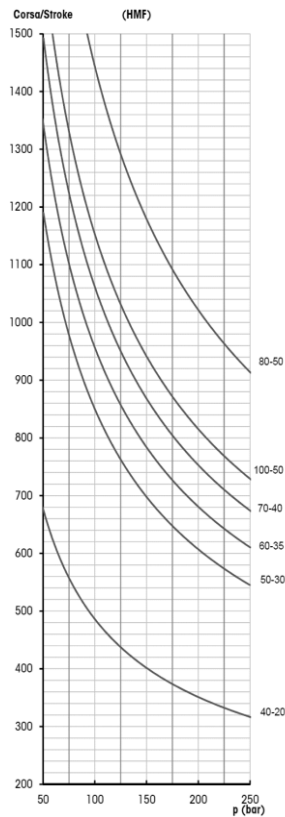

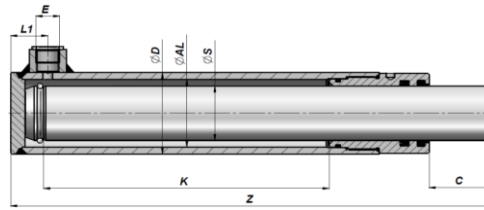

| Varenr. Code | K | Z | kg | E BSP | L1 | C |
|---------------------------------|-----|-----|-------|----------|----|----|
| ØD 50 ØAL 40 ØS 30 | | | | | | |
| HT02300200 | 200 | 326 | 3,64 | 3/8" | 23 | 40 |
| HT02300250 | 250 | 376 | 4,19 | | | |
| HT02300300 | 300 | 426 | 4,75 | | | |
| HT02300350 | 350 | 476 | 5,31 | | | |
| HT02300400 | 400 | 526 | 5,86 | | | |
| HT02300500 | 500 | 626 | 6,96 | | | |
| ØD 60 ØAL 50 ØS 40 | | | | | | |
| HT03400200 | 200 | 338 | 5,64 | 3/8" | 26 | 45 |
| HT03400300 | 300 | 438 | 7,29 | | | |
| HT03400400 | 400 | 538 | 8,98 | | | |
| HT03400500 | 500 | 638 | 10.61 | | | |
| HT03400600 | 600 | 738 | 12.28 | | | |
| ØD 70 ØAL 60 ØS 50 | | | | | | |
| HT04500300 | 300 | 450 | 10.47 | 3/8" | 30 | 50 |
| HT04500400 | 400 | 550 | 12.86 | | | |
| HT04500500 | 500 | 650 | 15.14 | | | |
| HT04500600 | 600 | 750 | 17.50 | | | |

CYL. RØR : STÅL St 52.3 DIN 2393 ISO H9

MATERIALE STANG : STÅL UNI C45 SAE 1045 CROMO 25 MICRON ±5 Rating 9 / 120 h ISO 10289 - 1999/ISO 9227-NSS

TUBE MATERIAL : STEEL St 52.3 DIN 2393 ISO H9

ROD MATERIAL : STEEL UNI C45 SAE 1045 CHROME 25 MICRON ±5 Rating 9 / 120 h ISO 10289 - 1999/ISO 9227-NSS

TEKNISKE SPECIFIKATIONER
TECHNICAL SPECIFICATIONS

TYPE "HTO"

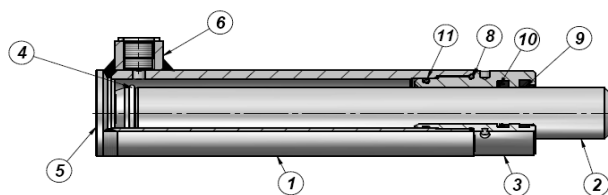

"HTO" Max Tryk - Max. Pressure : 250 bar (**)

TYPE "HFRT"

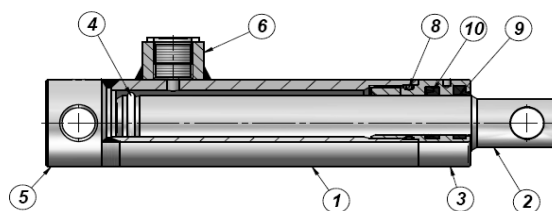

"HFRT" Max Tryk - Max. Pressure : 250 bar (**)

| PRODUKT - PRODUCT | | | MATERIALE - MATERIAL | |
|-------------------|---|--------------------------------|--|---|
| 1 | CYL.RØR POLISHED TUBE | | STÅL : St 52.3 DIN 2393 ISO H9 STEEL : St 52.3 DIN 2393 ISO H9 | |
| 2 | STEMPELSTANG CHROMED ROD | | STÅL : UNI C45 - SAE 1045 - CROMO 25 Micron ±5 Rating 9 / 120 h ISO 10289 - 1999/ISO 9227-NSS STEEL : UNI C45 - SAE 1045 - CHROME 25 Micron ±5 Rating 9 / 120 h ISO 10289 - 1999/ISO 9227-NSS | |
| 3 | PAKBOKS HEAD-BUSH | TYPE : "HTO" TYPE : "HTO" | STØBEGODS HYDRAULIC CAST IRON | UNI 5007-G25 UNI 5007-G25 |
| 3 | PAKBOKS HEAD-BUSH | TYPE : "HFRT" TYPE : "HFRT" | STÅL 9SMn28 MED "NI-TEMPER" BEHANDLING STEEL 9SMn28 WITH "NI-TEMPER" TREATMENT | |
| 4 | LÅSERING STOP RING | | STÅL : 9SMn28 STEEL : 9SMn28 | |
| 5 | ENDEBUND END-PLUG | | STÅL : S355J0 (Fe510C) - S355JR (A105) STEEL : S355J0 (Fe510C) - S355JR (A105) | |
| 6 | TILSLUTNINGSTUDS THREADED PORT | | STÅL : 9SMn28 - C22 STEEL : 9SMn28 - C22 | |
| 8 | PAKNING : O-RING SEAL O-RING | TYPE : "HTO" TYPE : "HTO" | NBR 70 SHORE NBR 70 SHORE | |
| 8 | PAKNING : O-RING SEAL O-RING | TYPE : "HFRT" TYPE : "HFRT" | NBR 90 SHORE NBR 90 SHORE | |
| 9 | PAKNING : GHK SEAL GHK | | POLYURETHAN POLYURETHANE | |
| 10 | PAKNING : TSE-TTS-TTI/L SEAL TSE-TTS-TTI/L | | TSE : NBR+FABRIC TSE : NBR+FABRIC | TTS-TTI/L: POLYURETHAN TTS-TTI/L: POLYURETHANE |
| 11 | PAKNING : O-RING SEAL O-RING | | NBR 70 SHORE NBR 70 SHORE | |

Max Hastighed - Top Speed : max 0,5 m/s

Temperatur C° - Temperature C° : -25 °C - +80 °C

(**) Spidsbelastningen bør altid kontrolleres afhængigt af brugen af cylindrene.
 (**) The pressure value is always to be checked depending on the application of the cylinders.

TEKNISKE SPECIFIKATIONER
TECHNICAL SPECIFICATIONS

TRYKKRAFT - OUTPUT FORCE (HTO)

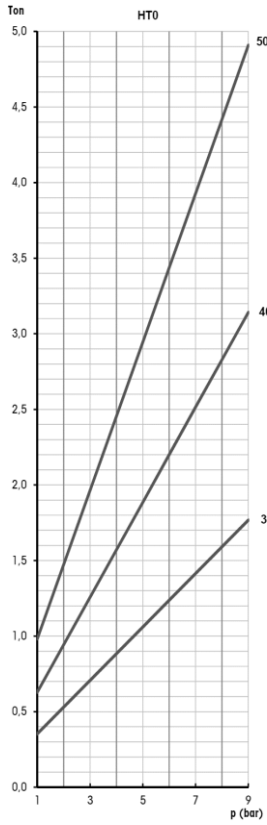

TRYKKRAFT - OUTPUT FORCE (HFRT)

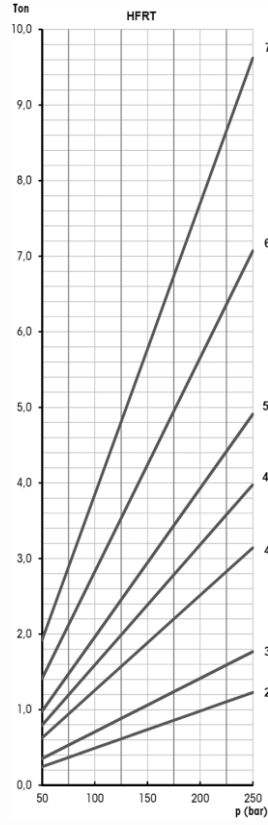

UDBØJNING - BUCKLING (HTO)

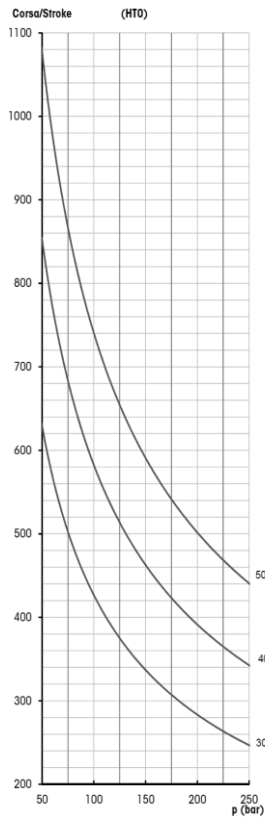

UDBØJNING - BUCKLING (HFRT)

